



ELECTRICAL LEGEND  
LIGHT FIXTURE SCHEDULE

SYMBOL	DESCRIPTION
--------	-------------



 — LED RECESSED TROFFER - 4000 LUMENS  
 40 WATT - 4100 KELVIN - ACRYLIC LENS  
 120-277V - TCP R24D4041K OR approved equal.

 — LED 5 TO 6 INCH RECESSED LIGHT - 10.8 WATT  
 DIMMABLE - 650 LUMENS - LUMEGEN  
 OR approved equal.

**B** — 4 FOOT LED SUSPENDED LINEAR FIXTURE, 50W,  
100-277VBEAMLED-4-50W-DM010-UNV-40K

**C** — 8 FOOT LED SUSPENDED LINEAR FIXTURE, 100W,  
100-277VBEAMLED-8-100W-DM010-UNV-40K  
WATER PROOF



 6" RETROFIT SOFT WHITE LED RECESSED LIGHT  
WITH BAFFLE TRIM 10.2 watts  
HALO LT560WH6930

 EMERGENCY EGRESS LIGHT FIXTURE  
SEE LIGHT FIXTURE SCHEDULE

— UNIVERSAL EXIT LIGHT FIXTURE WITH BATTERY  
BACK-UP-SEE LIGHT FIXTURE SCHEDULE

### ELECTRICAL LEGEND

### ELECTRICAL LEGEND

 — SMOKE DETECTOR (120VAC)  
 — EXHAUST FAN 180W

— DUPLEX RECEPTACLE-MT 18" AFF-20A,125VAC  
360W, 120V, QUADPLEX RECEPTACLE

— GFI RECEPTACLE-MT 18" AFF CIRCUIT, 20A, 125VAC

— OCCUPANCY LIGHT/MOTION SENSOR  
(MEGR PRS #W/SP200 W/ 120/277V)

LEXINGTON HODGSON HALL, C/O MT. SELE, CONTAINED

OS  
OCCUPANCY SENSOR, COMMERCIAL GRADE -  
WHITE, 1000MIL/IN (1000VA FL 120V)

XXX



EXHAUST FAN IN RESTROOM

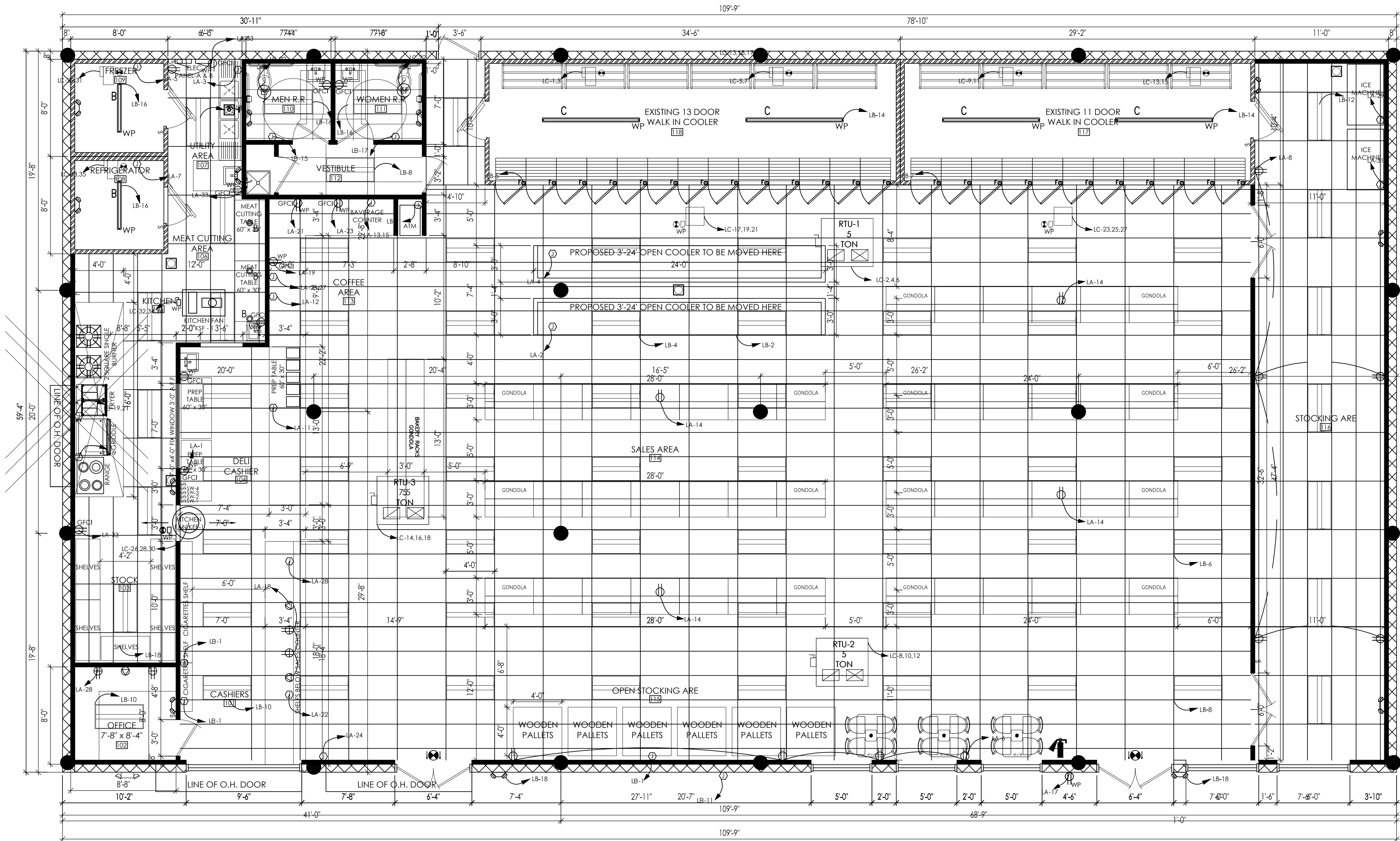

PROJECT NAME: C-STORE @ NEW WAVERLY										NOTE: CONTRACTOR SHALL PROVIDE A PERMANENTLY AFFIXED LABEL SHALL BE APPLIED WITH THE FAULT CURRENT @ INSTALLATION AND CALCULATION									
PROJECT NUMBER:										PROJECT NAME: C-STORE @ NEW WAVERLY									
PANEL:										PANEL:									
VOLTAGE:										VOLTAGE:									
LA 120/208V, 3PH, 4W NEMA-1										LB 120/208V, 3PH, 4W NEMA-1									
A I.C RATING BUS: 100 AMP COPPER										A I.C RATING BUS: 100 AMP COPPER									
MOUNTING SURFACE MOUNTED LOCATION: ELECTRICAL ROOM										MOUNTING SURFACE MOUNTED LOCATION: ELECTRICAL ROOM									
CODES:										CODES:									
CIRCUITS DESCRIPTION										CIRCUITS DESCRIPTION									
BKR CKT PH CKT BKR										BKR CKT PH CKT BKR									
LOAD										LOAD									
WIRE										WIRE									
CODE										CODE									
1 12 360 RCPTS-PREPARATION TABLE 20/1 1 A 2 20/1 JUNC BOX - OPEN COOLER 1000 12 2										2 12 1500 J-BOX FOR FUTURE USE 20/1 1 A 2 20/1 LGTS - SALES AREA 280 12 0									
2 12 500 JUNC BOX - UTILITY AREA 20/1 3 B 4 20/1 JUNC BOX - OPEN COOLER 1000 12 2										2 12 1300 LTGS-COOLER 20/1 5 B 4 20/1 LGTS - SALES AREA 400 12 0									
2 12 840 2 DOORS REFRIGERATOR 34CUBIC FT 20/1 5 C 6 20/1 RCPTS - SALES AREA 720 12 1										2 12 110 20/1 9 C 6 20/1 LGTS - SALES AREA 560 12 0									
2 12 1308 2 DOORS FREEZER 34CUBIC FT 20/1 7 A 8 20/1 RCPTS - STORE 900 12 1										2 12 1200 ATM 20/1 5 B 10 20/1 LGTS - CASHIER/OFFICE 240 12 0									
2 12 750 KOHLR HOOD (SHUNT -TRIP BKR) 20/1 9 B 10 20/1 SPARE										2 12 1000 MAIN SIGN 20/1 11 C 12 20/1 LGTS - STORAGE 400 12 0									
1 6 500 RCPTS - FOOD PREP TABLE 20/1 11 C 12 20/1 COLD SODA MACHINE 1200 12 2										2 12 1000 SPARE 20/1 13 A 14 20/1 LGTS - WALK-IN COOLER/STORAGE 400 12 0									
2 12 1350 COFFEE MACHINE 20/2 13 A 14 20/1 FLOOR RCPTS - SALES AREA 720 12 1										2 10 1725 ELECT HAND DRYER 25/1 15 B 16 20/1 LGTS - RESTROOM/VESTIBULE/FREEZER/REFRIDGERATOR 200 12 0									
2 12 1350 15 B 16 20/1 SPARE										2 10 1725 ELECT HAND DRYER 25/1 17 C 18 20/1 LGTS - KITCHEN/STOCK 320 12 0									
2 12 864 ICE MACHANDIZER 20/1 17 C 18 20/1 COMPUTER RCPTS/RCPTS - CASHIER 720 12 1										2 10 1500 FRYER 20/1 19 A 20 20/1 SPARE									
2 12 1200 ICE MACHINE 20/1 19 A 20 20/1 SPARE										2 10 1500 20/1 21 B 22 20/1									
2 12 1200 ICE MACHINE 20/1 21 B 22 20/1										23 C 24 20/1									
2 12 1200 SODA DRINK FOUNTAIN 20/1 23 C 24 20/1 LOTTO MACHINE 1200 12 2										25 A 26 20/1									
2 12 2250 CAPPUCCINO MACHINE 30/2 25 A 26 20/1 SPARE										27 B 28 20/1									
2 12 2250 27 B 28 20/1 COMPUTER RCPTS/RCPTS - MANAGERS OFFICE 540 12 1										29 C 30 20/1									
2 6 3474 ICE MACHINE 50/1 29 C 30 20/1 SPARE										31 A 32 20/1									
2 6 3474 31 A 32 20/1										33 B 34 20/1									
1 12 360 RCPTS - ELECTRICAL ROOM 20/1 33 B 34 20/1										35 C 36 20/1									
SPARE 20/1 35 C 36 20/1										37 A 38 20/1									
41 C 42 20/1										39 B 40 20/1									
41 C 42 20/1										41 C 42 20/1									
LIGHTS RECEP EQUIP MOTORS EL HEAT PHASE F.T.L.										LIGHTS RECEP EQUIP MOTORS EL HEAT PHASE F.T.L.									
A 12.56										A 12.56									
B 7.95										B 7.95									
C 10.22										C 10.22									
TOTAL 30.73										TOTAL 30.73									
GRAND TOTAL 30.73										GRAND TOTAL 30.73									

XXX

ELEC POWER  
LAYOUT

E2.0



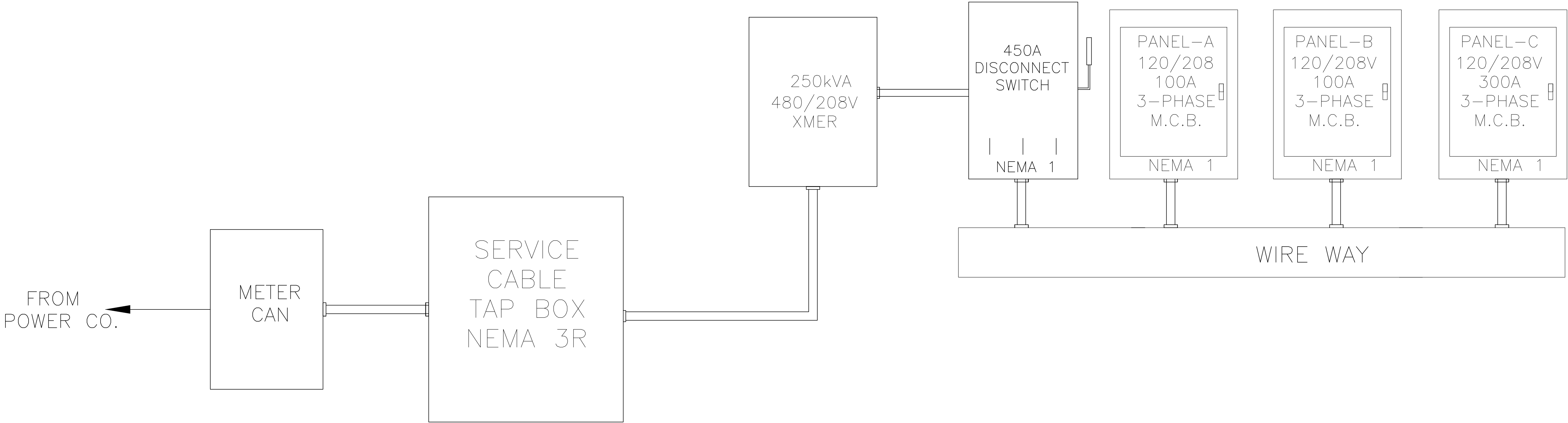

PROJECT NAME:			C-STORE @ NEW WAVERLY					NOTE: CONTRACTOR SHALL PROVIDE A PERMANENTLY AFFIXED LABEL SHALL BE APPLIED WITH THE FAULT CURRENT @ INSTALLATION AND CALCULATION														
PROJECT NUMBER:																						
PANEL:			LC					A.I.C RATING					22 KA									
VOLTAGE:			120/280V, 3PH, 4W NEMA-1					BUS: 300 AMP COPPER					MAINS: 300 AMP M.C.B					MOUNTING SURFACE MOUNTED LOCATION: ELECTRICAL ROOM				
CODES:			0=LIGHTS 1=RECEP 2=EQUIP 3=A/C 4=HTG 5=125% LGST MTR 6=KITCHEN 7=PREVIOUSLY CALCULATED																			
CODE	WIRE	LOAD	CIRCUIT DESCRIPTION					BKR	CKT	PH	CKT	BKR	CIRCUIT DESCRIPTION					LOAD	WIRE	CODE		
3	12	750	WALK-IN COOLER EVAPORATOR COILS					20/2	1	A	2	50/3	RTU-1 (SHUNT - TRIP BREAKER)					5032	6	5		
3	12	750	↓					↓	3	B	4	↓	↓					5032	6	5		
3	12	750	WALK-IN COOLER EVAPORATOR COILS					20/2	5	C	6							5032	6	5		
3	12	750	↓					↓	7	A	8	50/3	RTU-2 (SHUNT - TRIP BREAKER)					5032	6	5		
3	12	750	WALK-IN COOLER EVAPORATOR COILS					20/2	9	B	10	↓	↓					5032	6	5		
3	12	750	↓					↓	11	C	12							5032	6	5		
3	12	750	WALK-IN COOLER EVAPORATOR COILS					20/2	13	A	14	50/3	RTU-3 (SHUNT - TRIP BREAKER)					5032	6	5		
3	↓	750	↓					↓	15	B	16	↓	↓					5032	6	5		
3	6	3000	WALK-IN COOLER CONDENSING UNIT					50/3	17	C	18							5032	6	5		
3	6	3000	↓					↓	19	A	20	20/1	EF-1					100	12	2		
3	6	3000							21	B	22	20/1	EF-2					100	12	2		
3	10	1500	COOLER CONDENSING UNIT					20/3	23	C	24	20/1	SPARE									
3	10	1500	↓					↓	25	A	26	20/3	KITCHEN FAN KEF-1					375	12	2		
3	10	1500							27	B	28	↓	↓					375	12	2		
3	10	750	FREEZER EVAPORATOR COILS					20/2	29	C	30							375	12	2		
3	10	750	↓					↓	31	A	32	20/3	KITCHEN FAN KSF-1					471	12	2		
3	10	750	REFRIDGERATOR EVAPORATOR COILS					20/2	33	B	34	↓	↓					471	12	2		
3	10	750	↓					↓	35	C	36							471	12	2		
3	10	1500	FREEZER CONDENSING UNIT					20/3	37	A	38	20/3	FREEZER CONDENSING UNIT					1500	6	3		
3	10	1500	↓					↓	39	B	40	↓	↓					1500	6	3		
3	10	1500							41	C	42							1500	6	3		
		LIGHTS	RECEP.	EQUIP.	MOTORS	EL. HEAT	PHASE	F.T.L.				PHASE	CONN.KVA	LOAD FACTORS		DES. KVA	DES.AMP					
		0	0	11446	15096	15096	A					A	41.64	LIGHTS @ 125%		0	0.00					
		0	0	11446	15096	15096	B					B	41.64	EQUIP. @ 100%		37.24	103.44					
		0	0	14346	15096	15096	C					C	44.54	LG. MOTOR @ 125%		56.61	157.25					
		0	0	37238	45288	45288	TOTAL					TOTAL	127.81	RECEPS @ 10KW+50%		0.00	0.00					
														GRAND TOTAL		93.848	260.7					

xxx