

# Venus Pushchair Instruction Manual

PLEASE READ ALL INFORMATION CAREFULLY AND KEEP FOR  
FUTURE REFERENCE.  
FAILURE TO DO SO MAY RESULT IN INJURY TO YOUR CHILD!

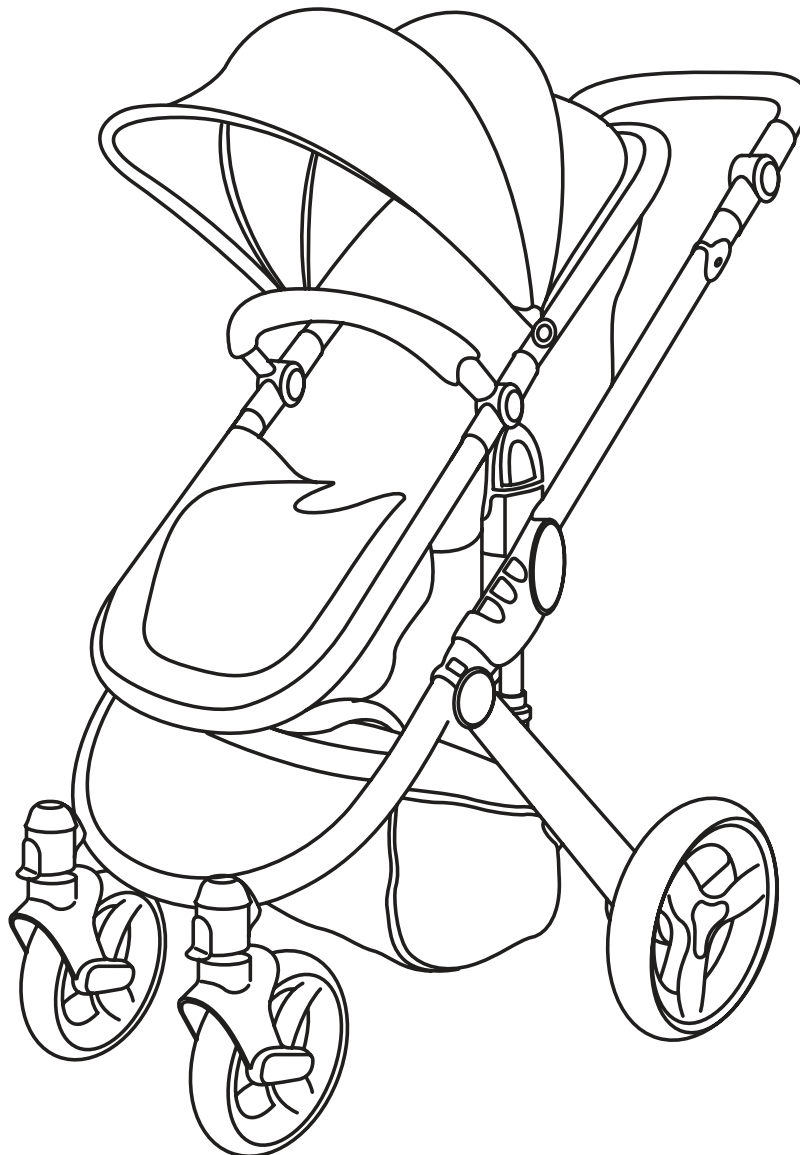

**ALLIS**<sup>®</sup>  
the modern baby

---

## SAFETY REQUIREMENTS

- This stroller is suitable for children from birth up to 3 years old.
- Maximum child height – 96cm
- Maximum child weight – 15kg
- Only suitable for 1 child.
- Storage basket holds up to 2kg
- Always use the restraint system (crotch belt in combination with the waist belt.) Use the shoulder straps to prevent injury from slipping or falling.
- Use the safety belts as soon as your child is capable to sit upright without assistance.
- Do not allow children to play or stand in the stroller.
- Do not use the stroller on uneven surfaces.
- Do not use the stroller near fire or other dangerous places.
- Do not use the stroller on stairs or escalators.
- Do not leave the stroller on hills or inclined surfaces even with brake system active.
- Engage parking device when placing and removing children in the stroller.
- Oil the wheels and metal parts regularly to ensure the stroller works at its best.

---

## WARNING

- ENSURE ALL LOCKING DEVICES ARE ENGAGED BEFORE USE!
- KEEP CHILD AWAY WHEN FOLDING AND UNFOLDING!
- THIS PRODUCT IS NOT A TOY – DO NOT LET YOUR CHILD PLAY WITH/ON.
- CHECK ALL ATTACHMENTS ARE CORRECTLY ENGAGED BEFORE USE.
- SEAT POSITION NOT SUITABLE FOR CHILDREN UNDER 6 MONTHS.
- NOT SUITABLE FOR RUNNING OR SKATING.
- THE CARRYCOT IS SUITABLE FOR A CHILD WHO CANNOT SIT UNAIDED, ROLL OVER AND CANNOT PUSH ONTO HANDS AND KNEES – MAXIMUM WEIGHT 9KG.

## MAINTENANCE AND CARE

- Use damp cloth to clean metal and plastic parts.
- Use upholstery cleaner for woven fabric.
- Check for damaged parts regularly and replace immediately.
- Oil castor bolts and wheels regularly.
- Do NOT place items in/on stroller when storing.
- Do NOT overload with extra items as extra weight affects stroller stability.

## ASSEMBLING

Follow the instructions below alongside the pictures shown in order to assemble your stroller:

1. Unfold the stroller by lifting the handle of the stroller upwards until it automatically locks into place.

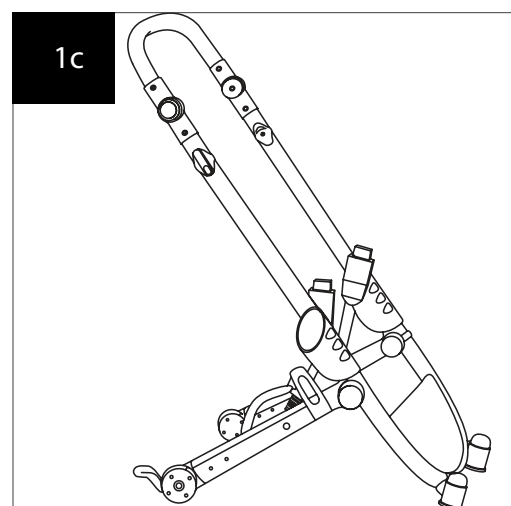
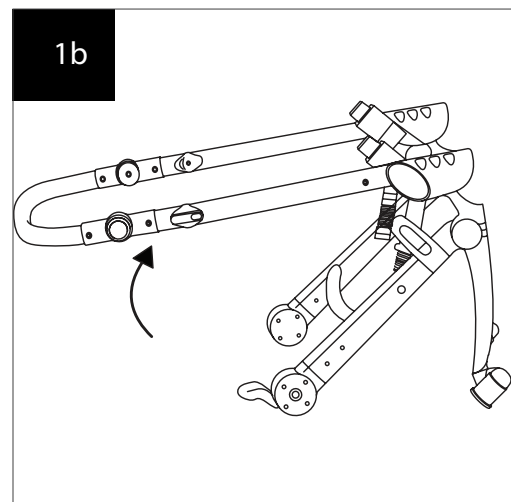
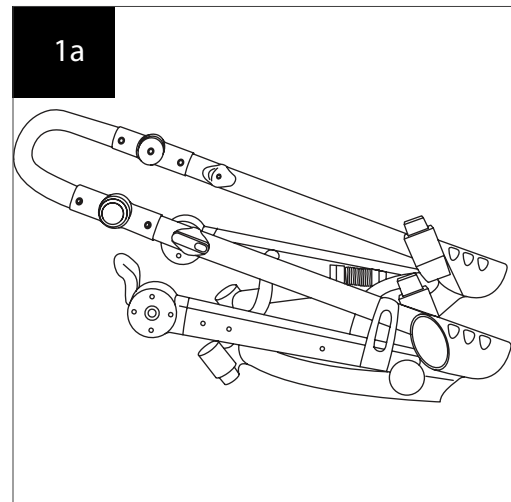

## ASSEMBLING

2. Insert rear wheels as shown.

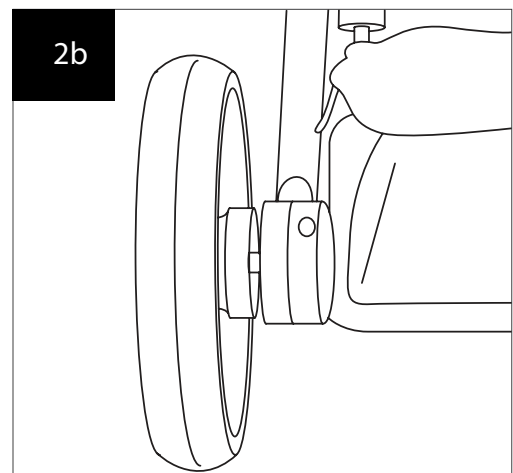
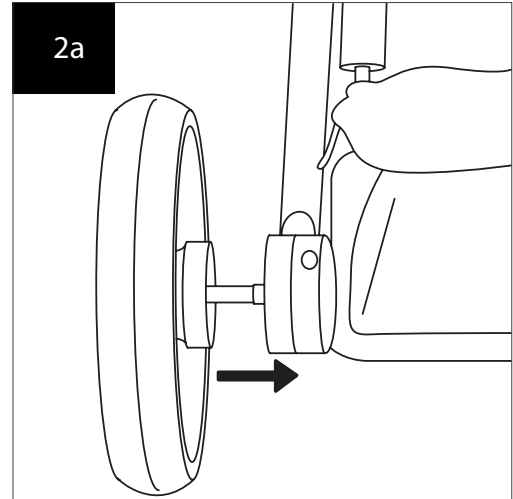

3. Insert front wheels and press upwards until they are securely fixed.

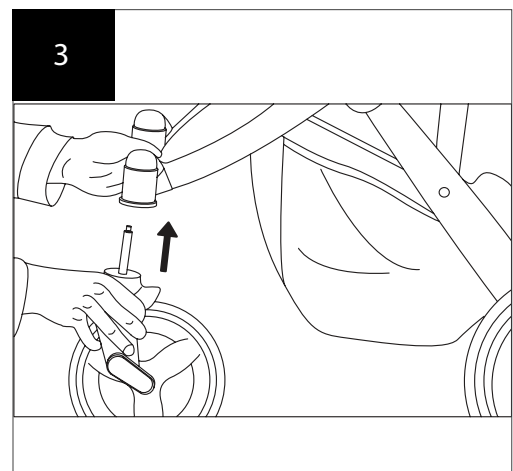

## ASSEMBLING

4. Install Carrycot – make sure clips are fixed in dedicated frame slots.

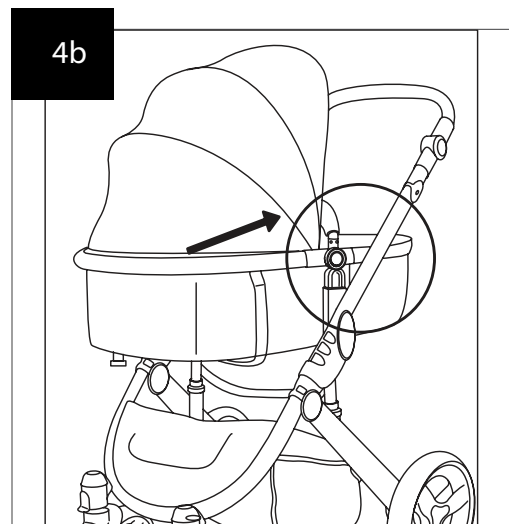
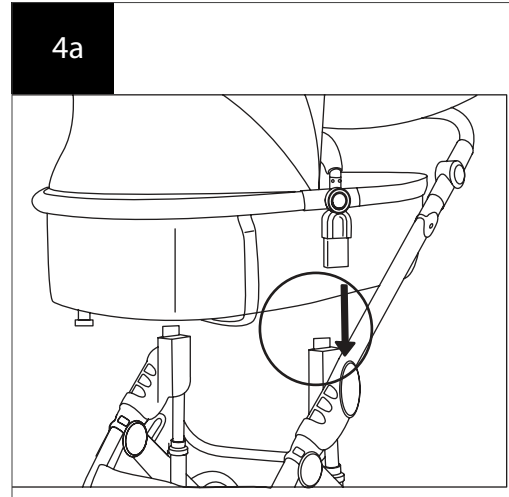

5. Install front bar by slotting into correct holes at the top of the Carrycot. To uninstall the front bar, press the buttons on both sides.

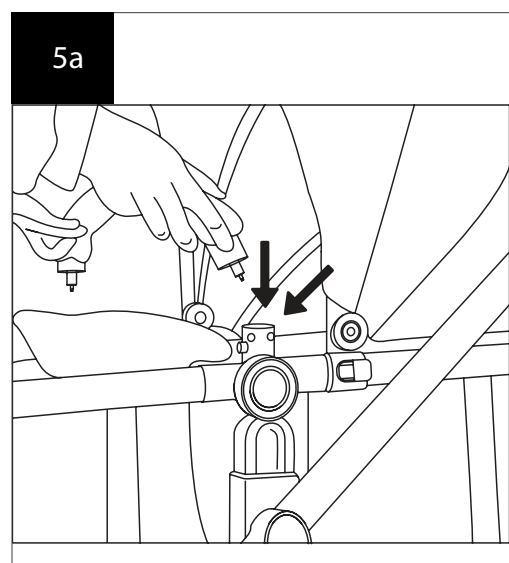

## ASSEMBLING

6. Adjust the backrest position by using the locking elements and two side buttons.

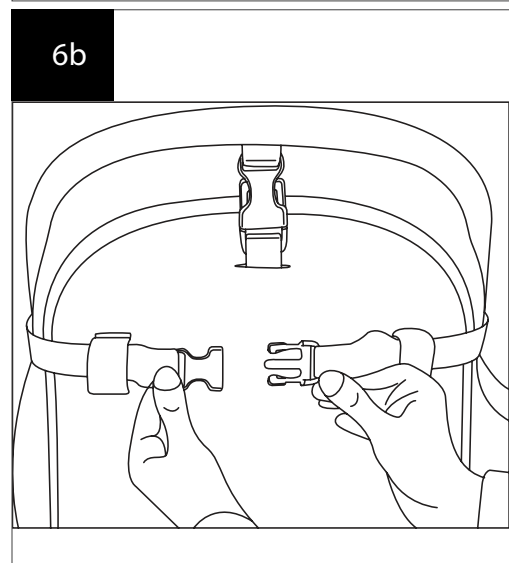
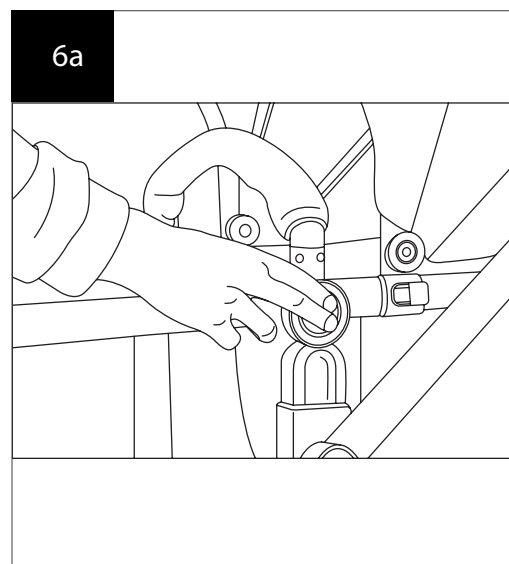
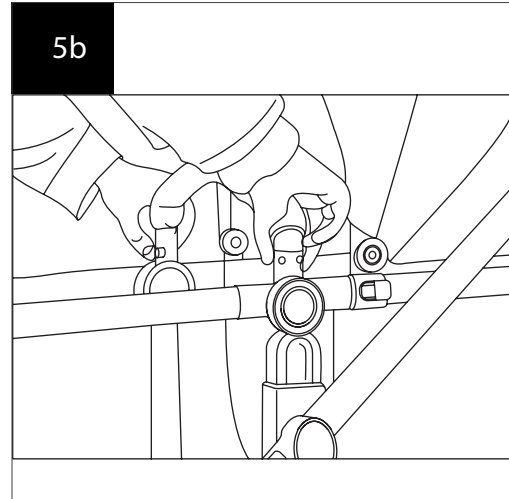

## ASSEMBLING

7. To remove the Carrycot, slide and hold down button (A) and press button (B), then press button (C) and lift out the Carrycot as shown.

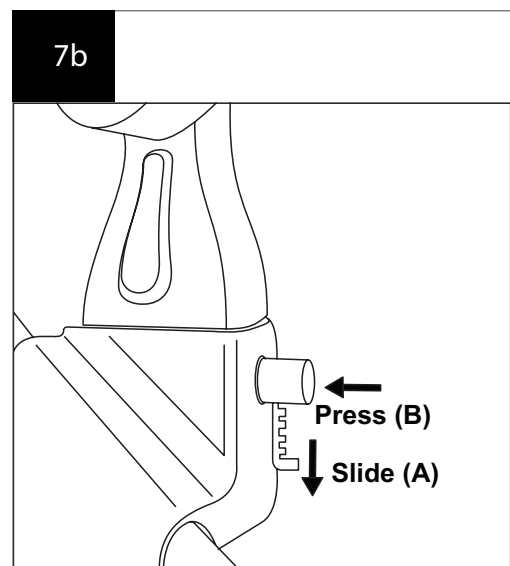
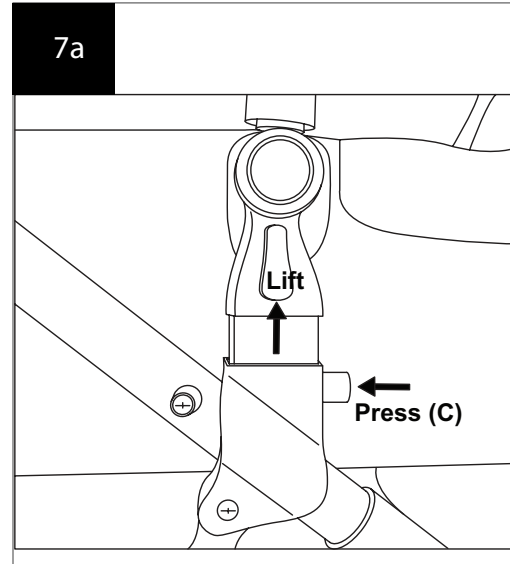



## USAGE

- Use brakes on the rear wheels to fix stroller in static position – Press brake pedal located on the rear axle

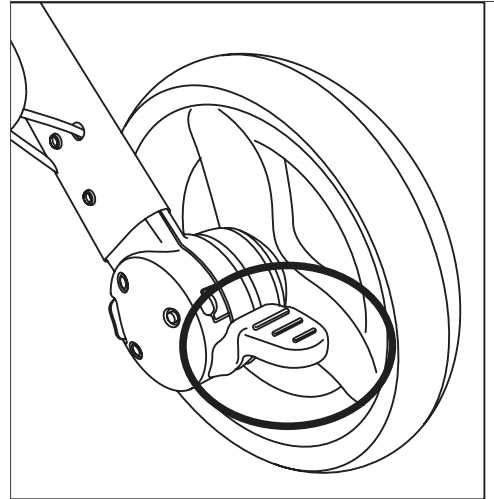

- To adjust the height of the handle, press the button mechanism and move to where you feel most comfortable.

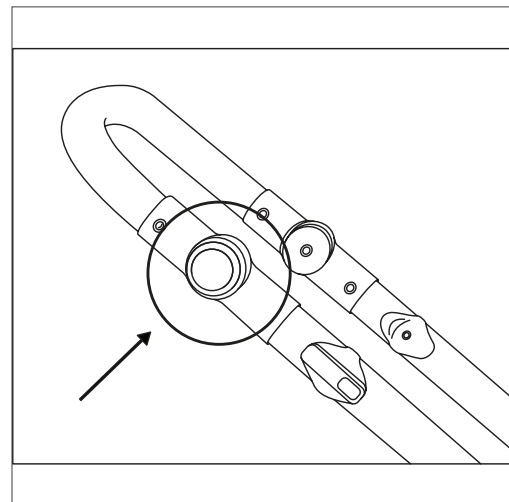

- To change position of the canopy, hold the upper part and pull down to the desired position.

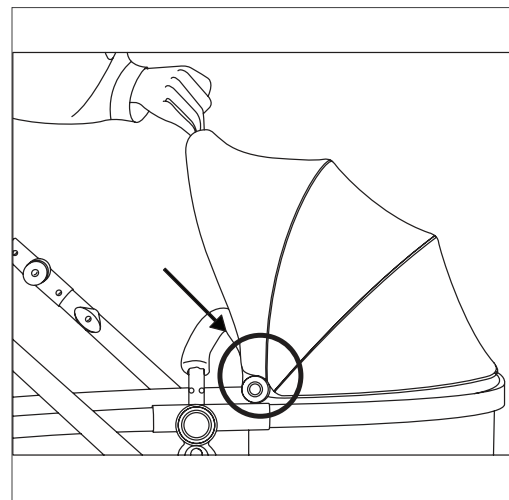

## USAGE

- To use a seat position you have to transform the carrycot first. Press buttons found on both sides simultaneously and rotate the basket.

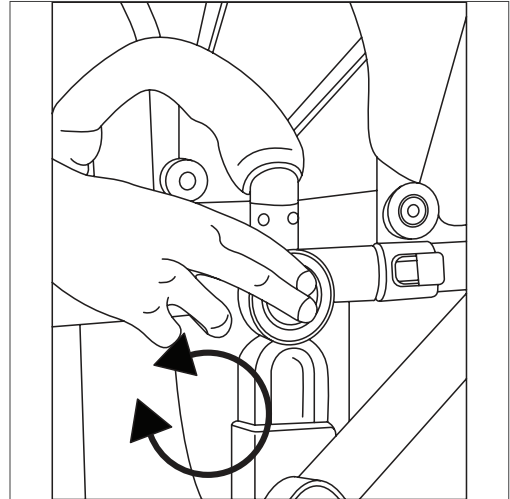

- When using the seat position **ALWAYS** use the safety belts.
- To lock the safety belts, connect elements 1 & 2.
- To unlock the safety belts you have to press 1 and pull out 2.

## FOLDING

1. Activate brake system.

2. Fold canopy to maximal position.

3. Press the button to release the right mechanisms.

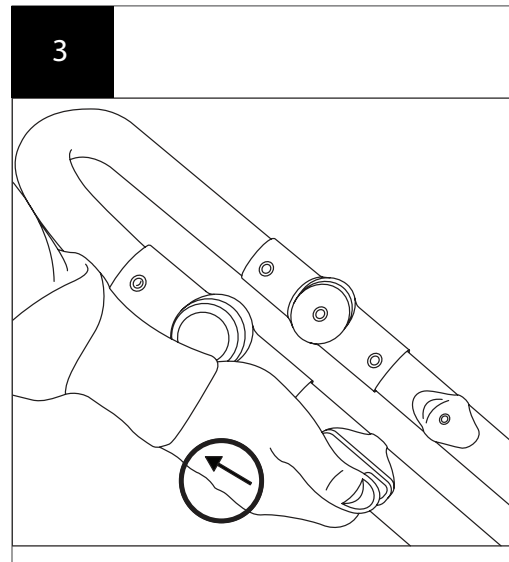

4. Correctly folded stroller.

