

**C O H E R E**



COHERE HOUSING PROJECT  
Group 6: Tara Sydney

Lisa Xiao-Lei Shao  
470254491  
BDES2027



# ABSTRACT



After a life of peril and turmoil, it is difficult for young refugees to integrate themselves back into normal life, let alone life in a completely foreign country. This Co-housing and Kitchen project aims to assist in the effort both in terms of its program as well as its architecture.

The building revolves around a co-operative kitchen, where both the refugee and student residents are encouraged to participate, mainly through the promise of deducted rent as well as a sense of fulfillment and empowerment from learning a useful skill and helping others. A head chef leads the program, teaching and managing the cooking for the entire day. Staff are involved in the planning, cooking, serving, and cleaning of the kitchen, and throughout this process, are pushed into developing communication and teamwork skills. Prepared food is sold at various recommended prices to both the local community as well as the residents themselves, and they are given a large, public space to dine and socialise in.

The main event of the entire program revolves around the serving and dining section of the process. Throughout this period of time, the residents (mainly the refugees) are encouraged to interact and socialise with the other residents as well as the local community to help them integrate into Australian society. Through conversing with them, refugees are given the chance to tell their story, helping them lessen their inner demons as well as spread awareness for the cause of assisting other refugees. Additionally, they are given the chance to learn from the local community, about the local community. Gaining this knowledge will help demystify the process of integrating themselves into this new, foreign society.

Architecturally, the project aims to create a comfortable living space that provides a multitude of communal spaces to socialise with the rest of the residents with, yet still maintains a sense of privacy when one needs it.

# B U S I N E S S P L A N





STAFF



HEAD CHEF

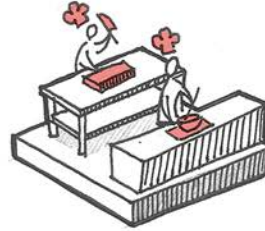

PREPARATION



REDUCING RENT



LERANING SKILLS

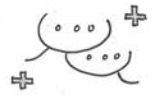

TEAMWORK



COMMUNITY



RESIDENTS



STAFF



SERVING

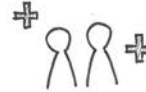

RELATIONSHIPS



REDUCING RENT

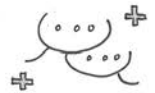

COMMUNICATION



COMMUNITY



RESIDENTS

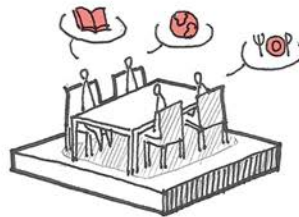

SOCIALISATION

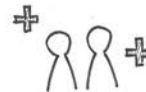

RELATIONSHIPS



CULTURE



COMMUNICATION

EXPERIENCE MAPPING

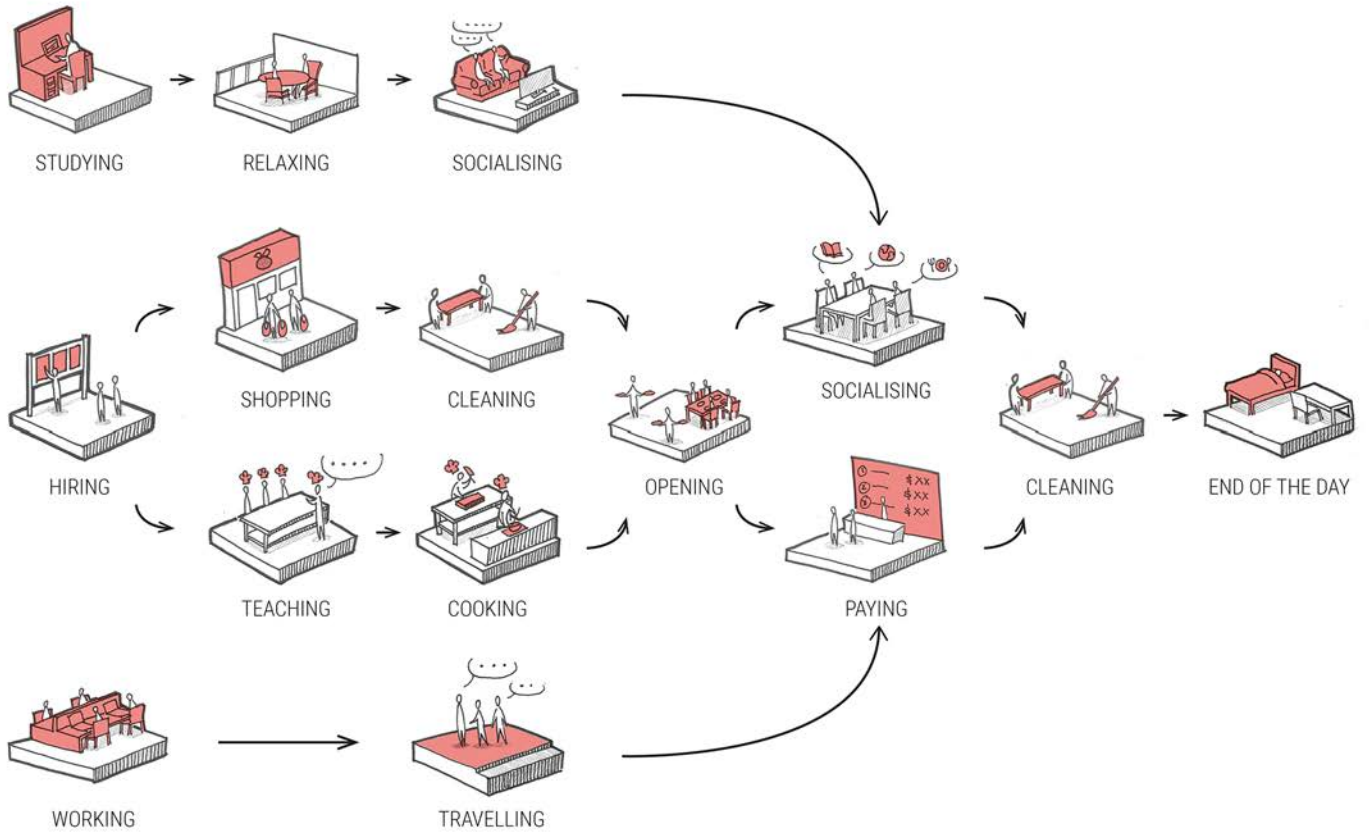



# **S I T E   A N D   S I T E   A N A L Y S I S**

2 G E R A L D S T R E E T





Winter Sun

Autumn / Spring Sun

Summer Sun





June 21st

9AM



June 21st

12PM



June 21st

3PM



March 21st / September 21st

9AM



March 21st / September 21st

12PM



March 21st / September 21st

3PM



December 22nd

9AM



December 22nd

12PM



December 22nd

3PM



# DESIGN PRINCIPLES



PRIVACY AND PERSONALISATION

01

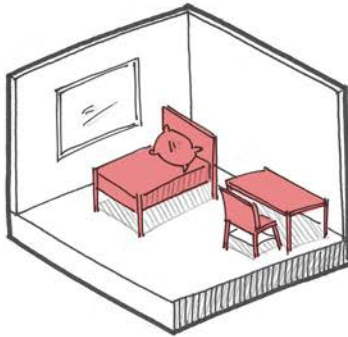
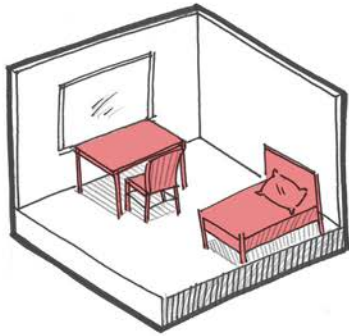

Single rooms with private bathrooms to create a sense of privacy and security and give residents the freedom to arrange the space to personalise their spaces

02

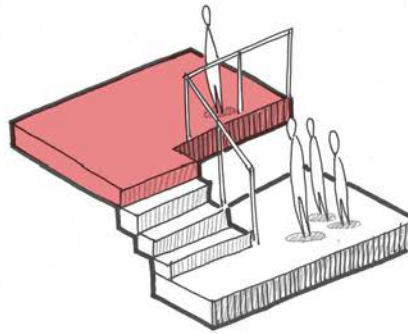

Elevated walkways that lead to individual rooms, creating a threshold moment that separates the common spaces from the private spaces and facilitates a sense of privacy

03

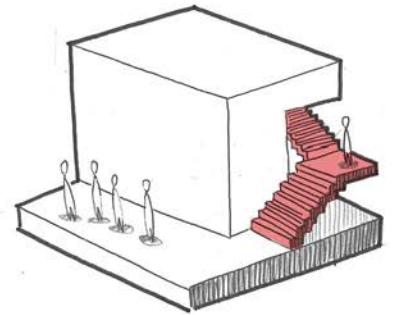

Entrance to housing is hidden to the side of the building to give a sense of privacy and security to the residents

04

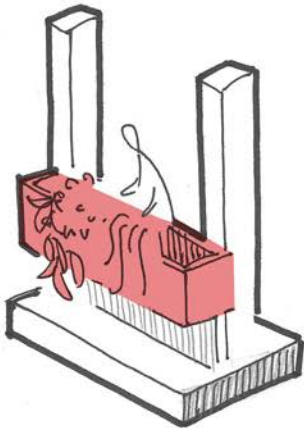

Small external balcony spaces that allow residents to get access to an external space that they have the freedom to design and personalise

05

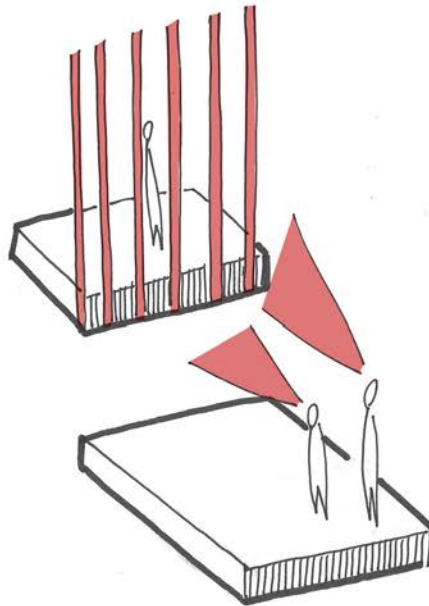

Fixed louvres covering south facing openings to provide privacy from the outside

06

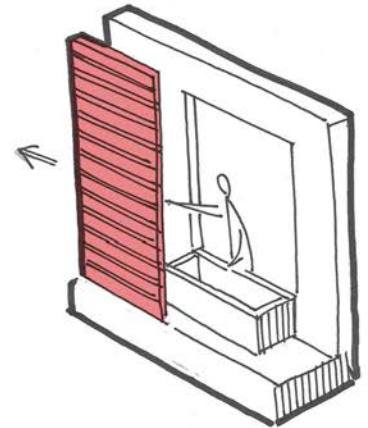

Operable louvres covering openings to provide residents with privacy while still allowing light into their rooms





C O M M U N I T Y

07

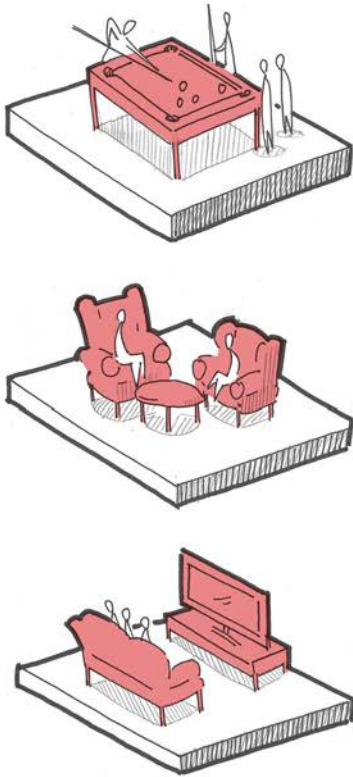

Multiple shared common spaces with different facilities within that are open to the entire building to entertain the residents and facilitate a sense of community

08

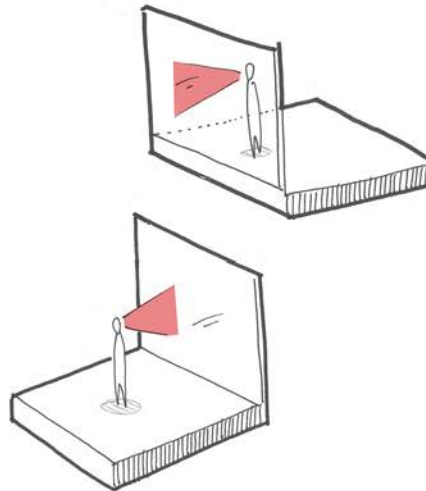

Large openings in communal spaces that face each other to allow views into other spaces to connect the spaces and facilitate a sense of community

09

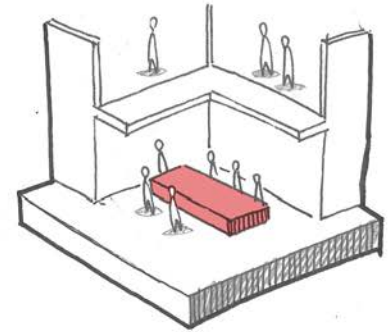

Skylights are open at the top of the kitchen to allow residents to view the ongoing activities within the kitchen while they are in the communal spaces to promote participation

10

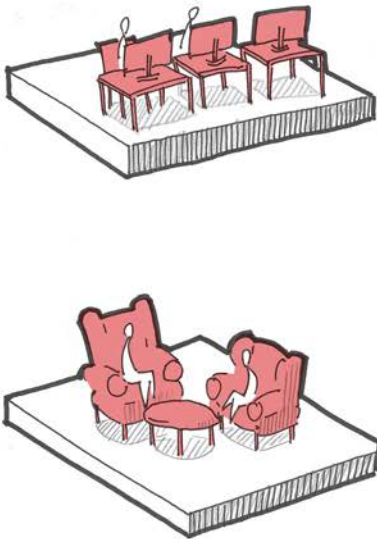

Access to commonly used student facilities such as computers and group study spaces to provide convenience for residents

11

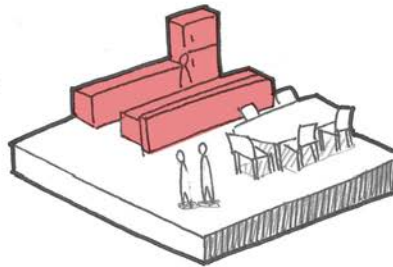

Communal kitchens and dining spaces on each floor to promote socialisation within the cohort residents

12

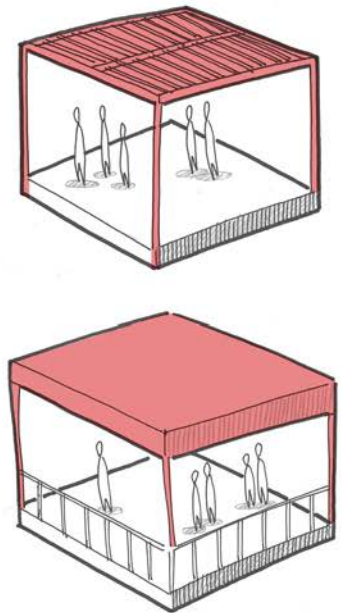

North Facing, semi balcony spaces with varying degrees of privacy provide residents with a pleasant outdoor space



C O M F O R T

13

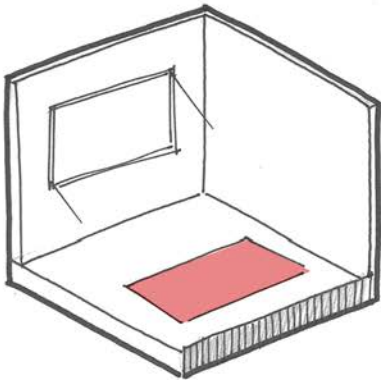

North facing windows for thermal comfort throughout winter by letting through maximum sunlight throughout the day with eaves to block out harsher summer sun

14

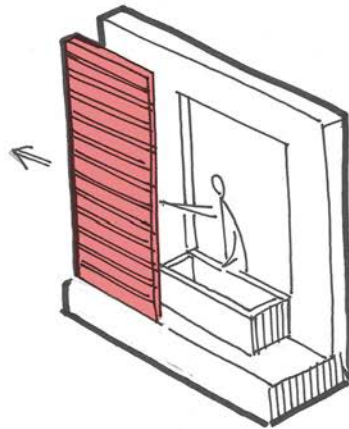

Operable louvres covering openings to assist in daylighting when sun becomes too bright, or for thermal comfort to protect the interior from becoming too warm due to the sun

15

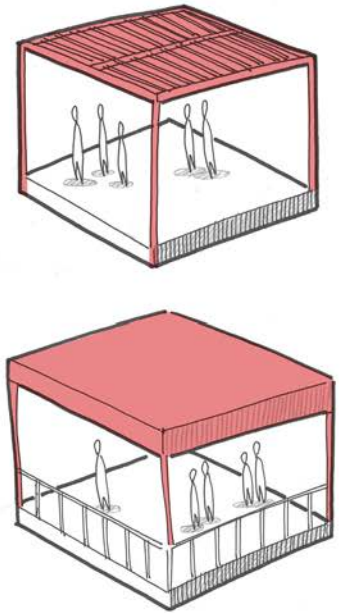

Outdoor spaces north facing and sufficiently shaded to ensure maximum thermal comfort for occupants while the space is being used

16

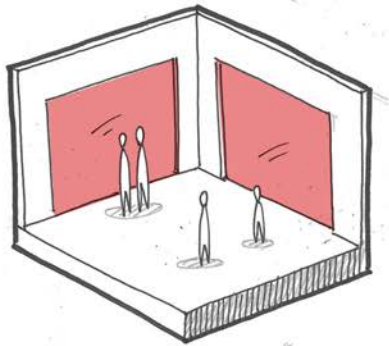

South facing openings in communal spaces to provide sufficient daylight without glare, and provide a pleasant view for occupants

17

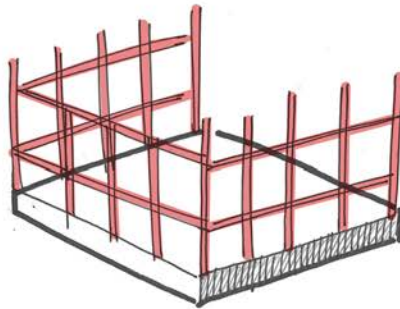

Timber frame construction with insulation to provide both thermal comfort, ease of construction and maintenance and a lower construction cost

18

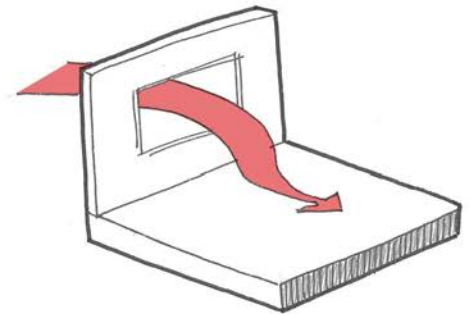

Many operable openings to allow for sufficient ventilation throughout the building for thermal comfort





**S P A T I A L   O R G A N I S A T I O N**

B U B B L E D I A G R A M



PUBLIC

PRIVATE

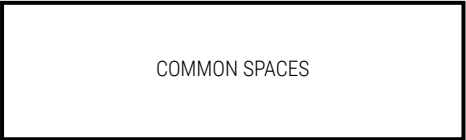

 PRIMARY SPACES

 SECONDARY SPACES

T H R E E - D I M E N S I O N A L F O R M

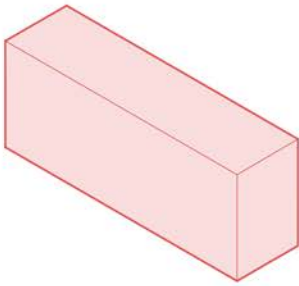

Placement on site

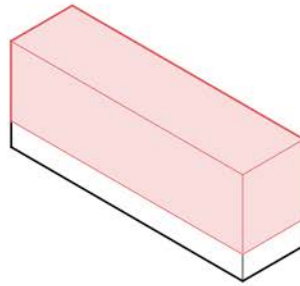

Allocating Living Spaces

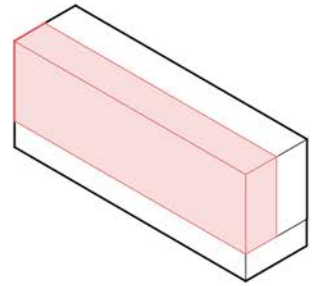

Allocating Private Spaces

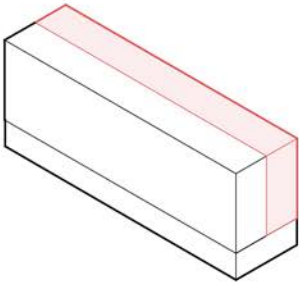

Allocating Communal Spaces

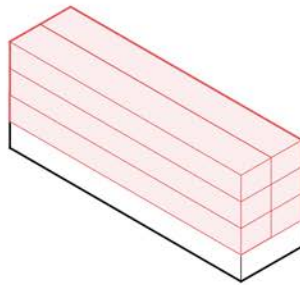

Dividing into Floors

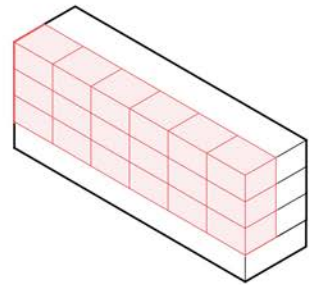

Allocating Rooms

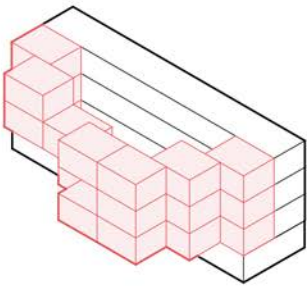

Shifting Rooms for better Placement

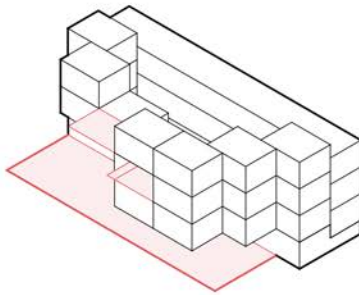

Allocating Outdoor Spaces

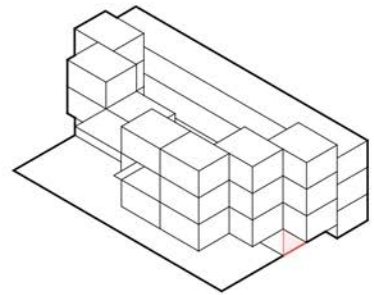

Creating Private Entrance

O V E R A L L   S P A T I A L   O R G A N I S A T I O N



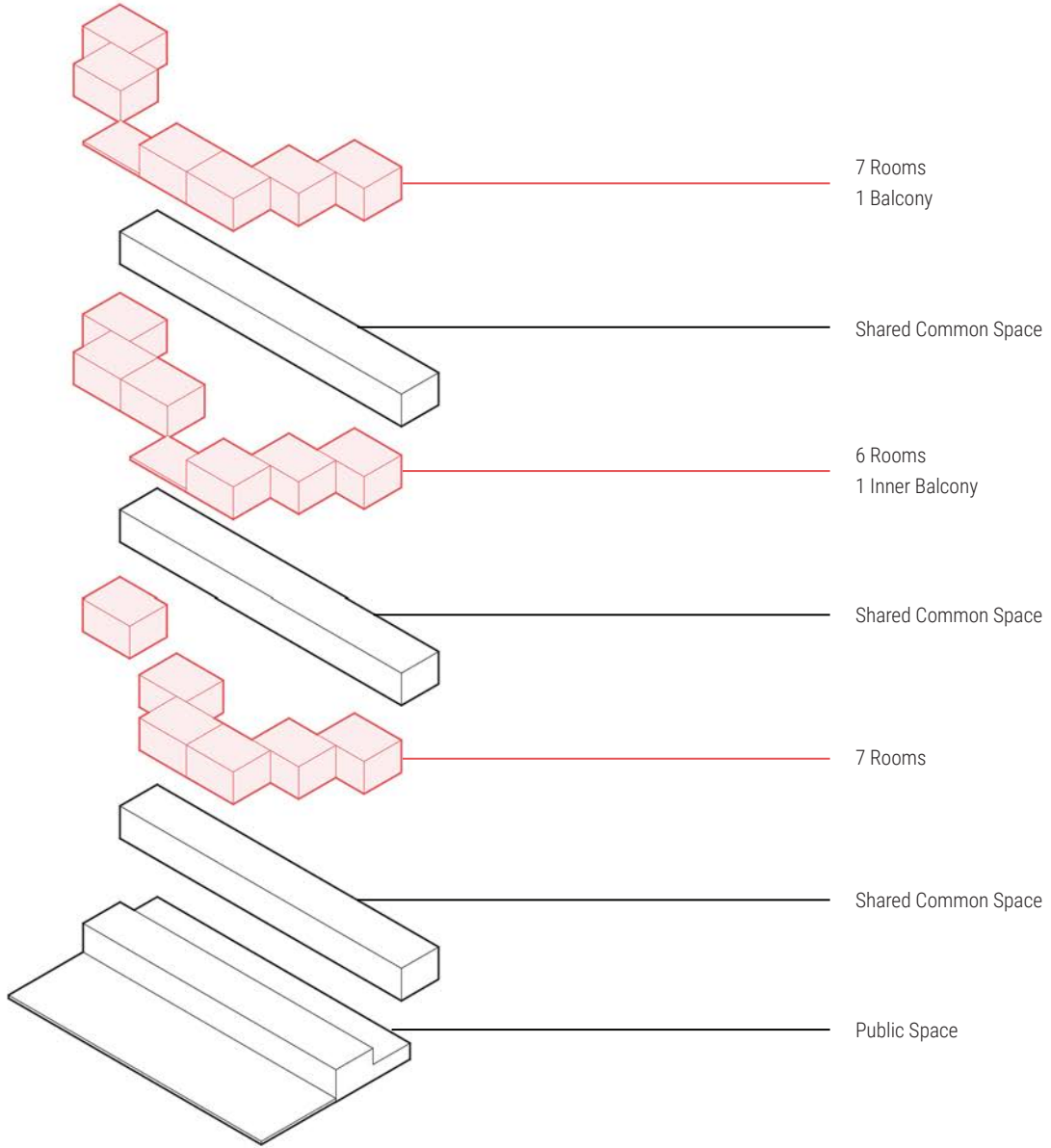

REFINED SPATIAL ORGANISATION

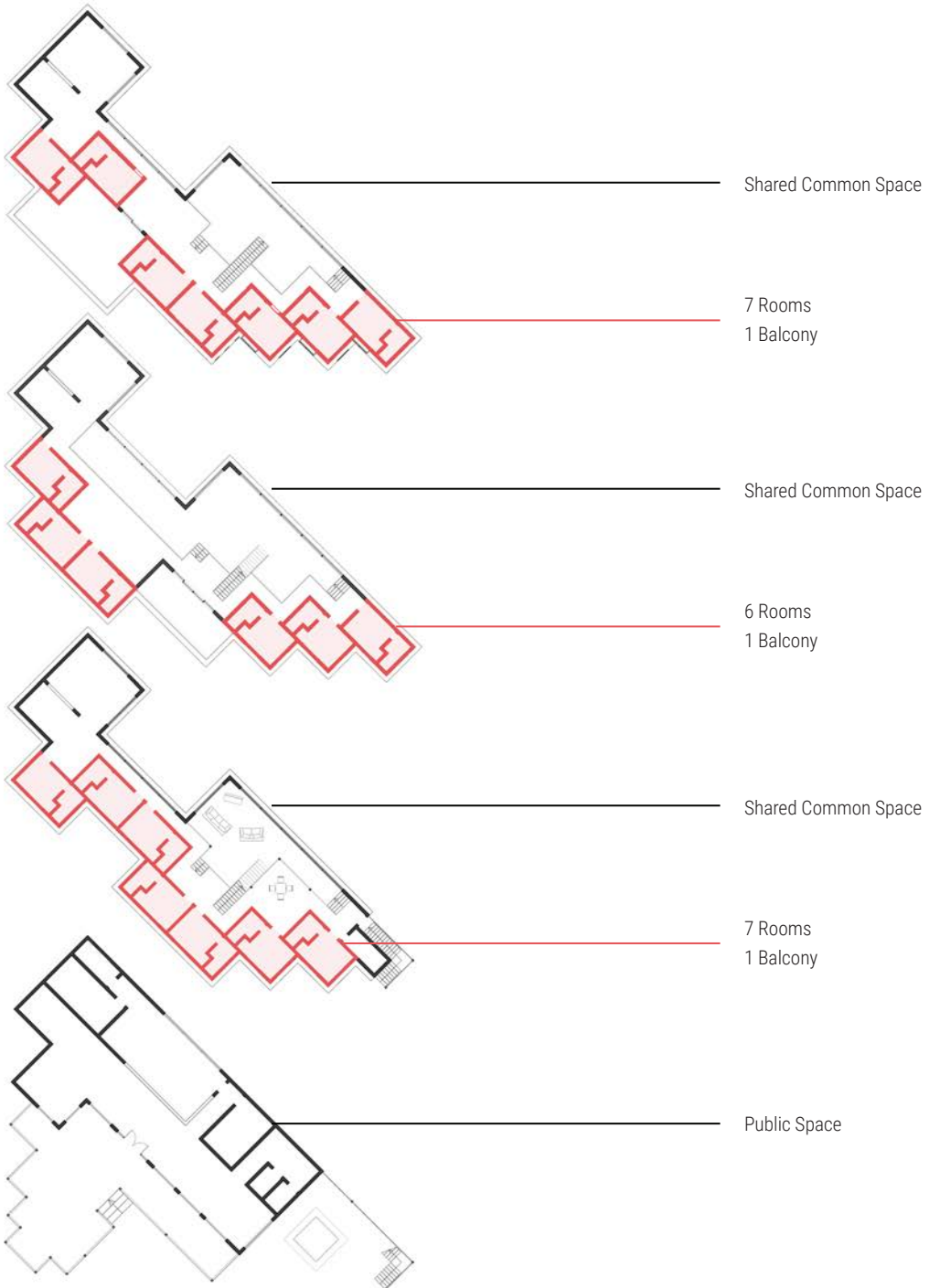



**T E C H N I C A L   D R A W I N G S**



# FLOOR PLANS





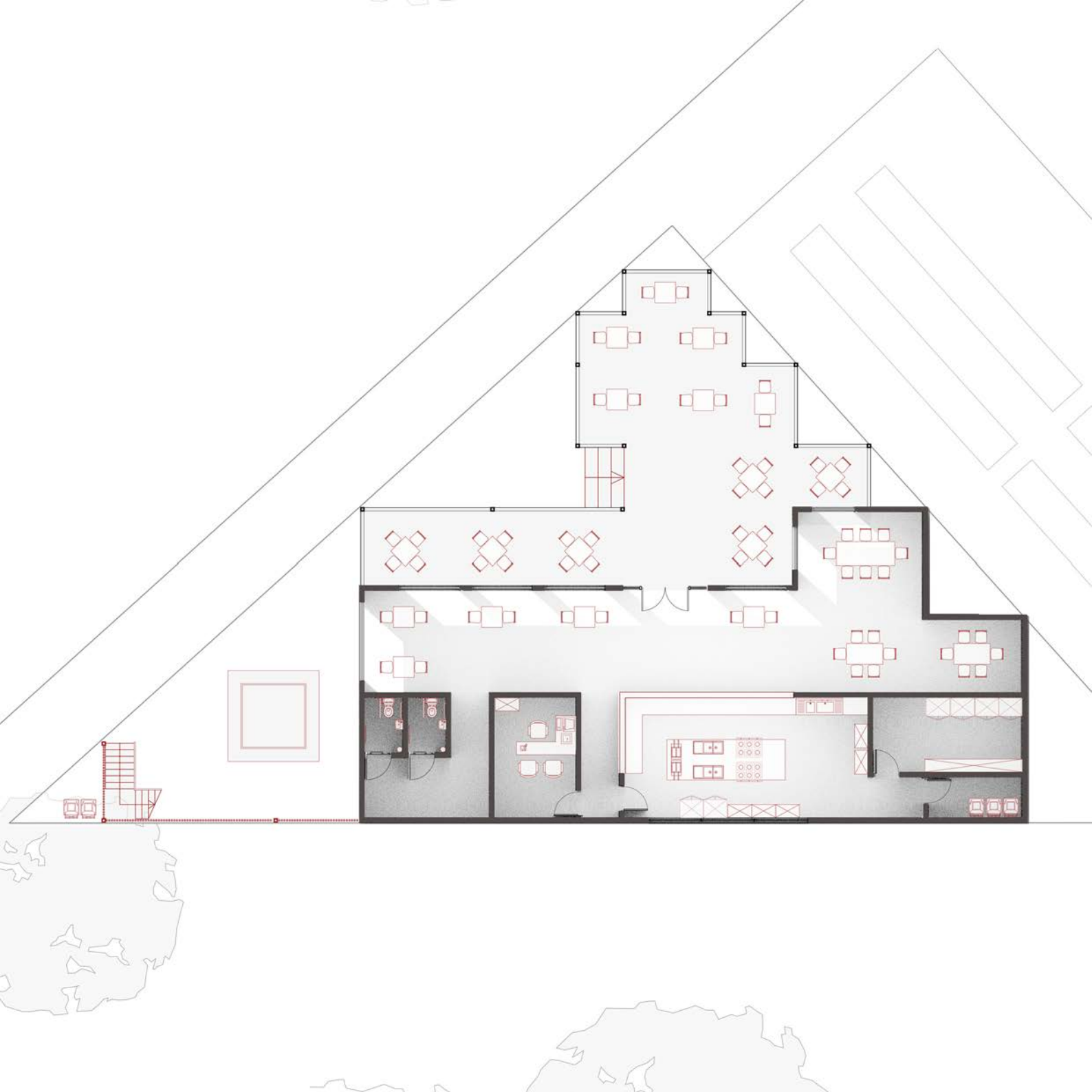



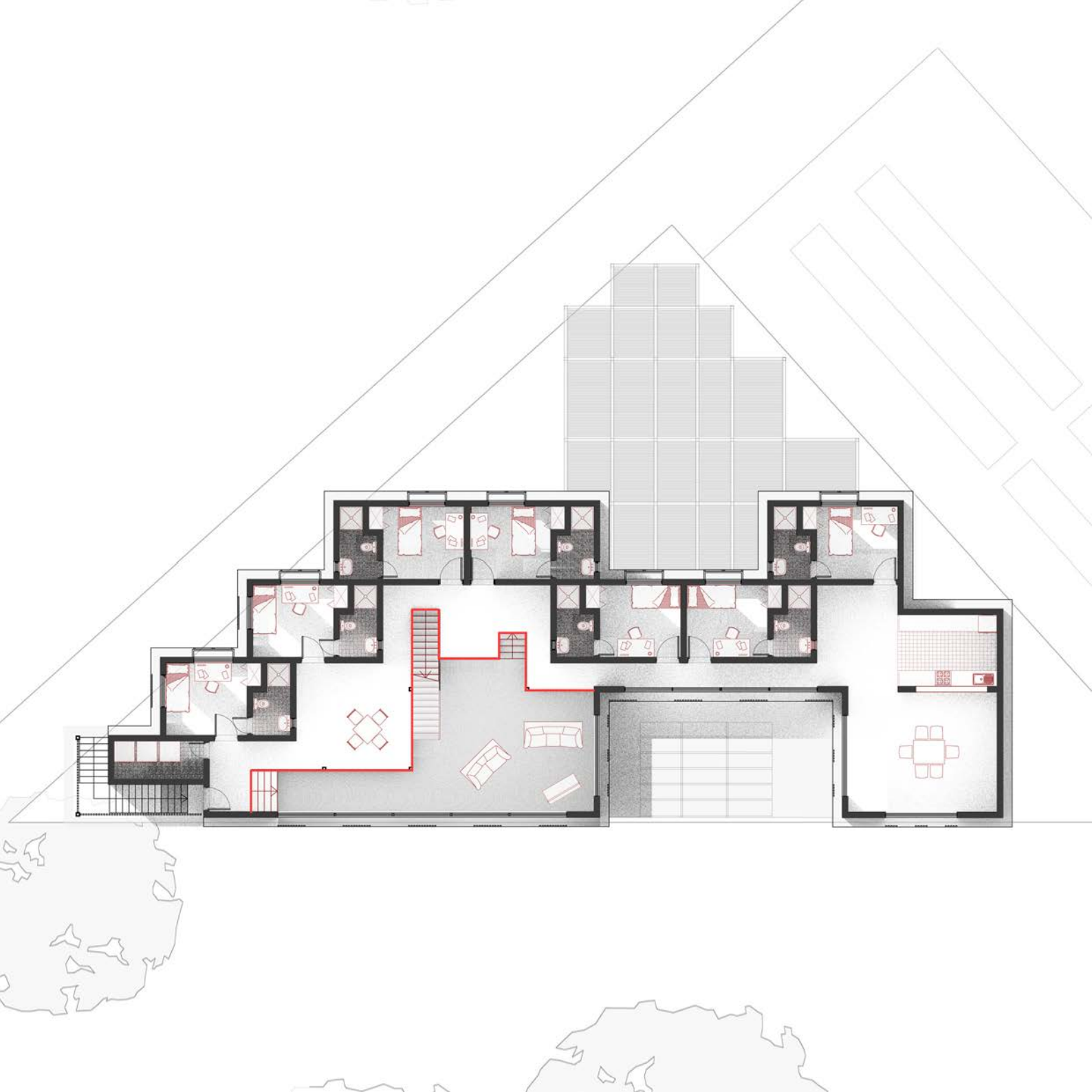



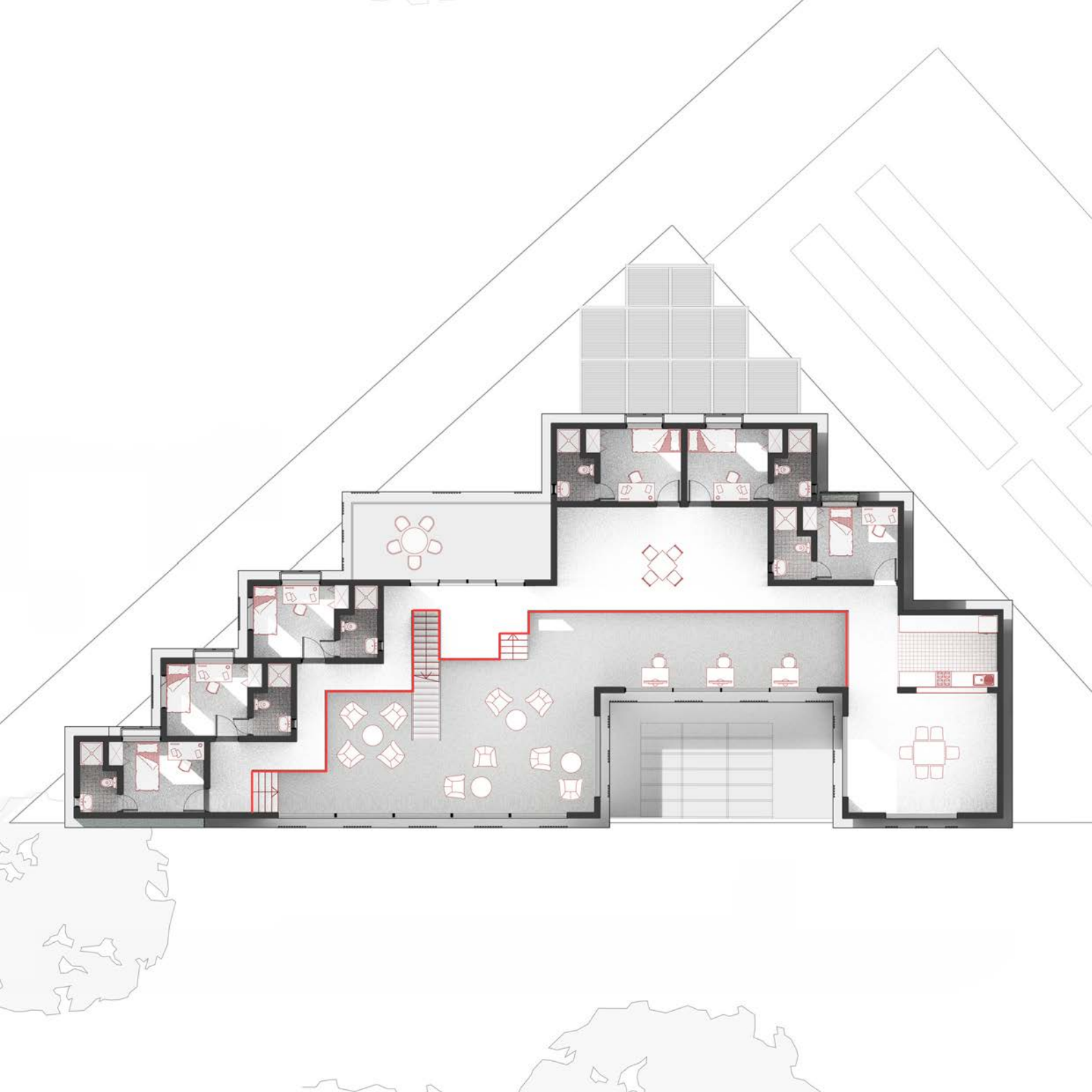



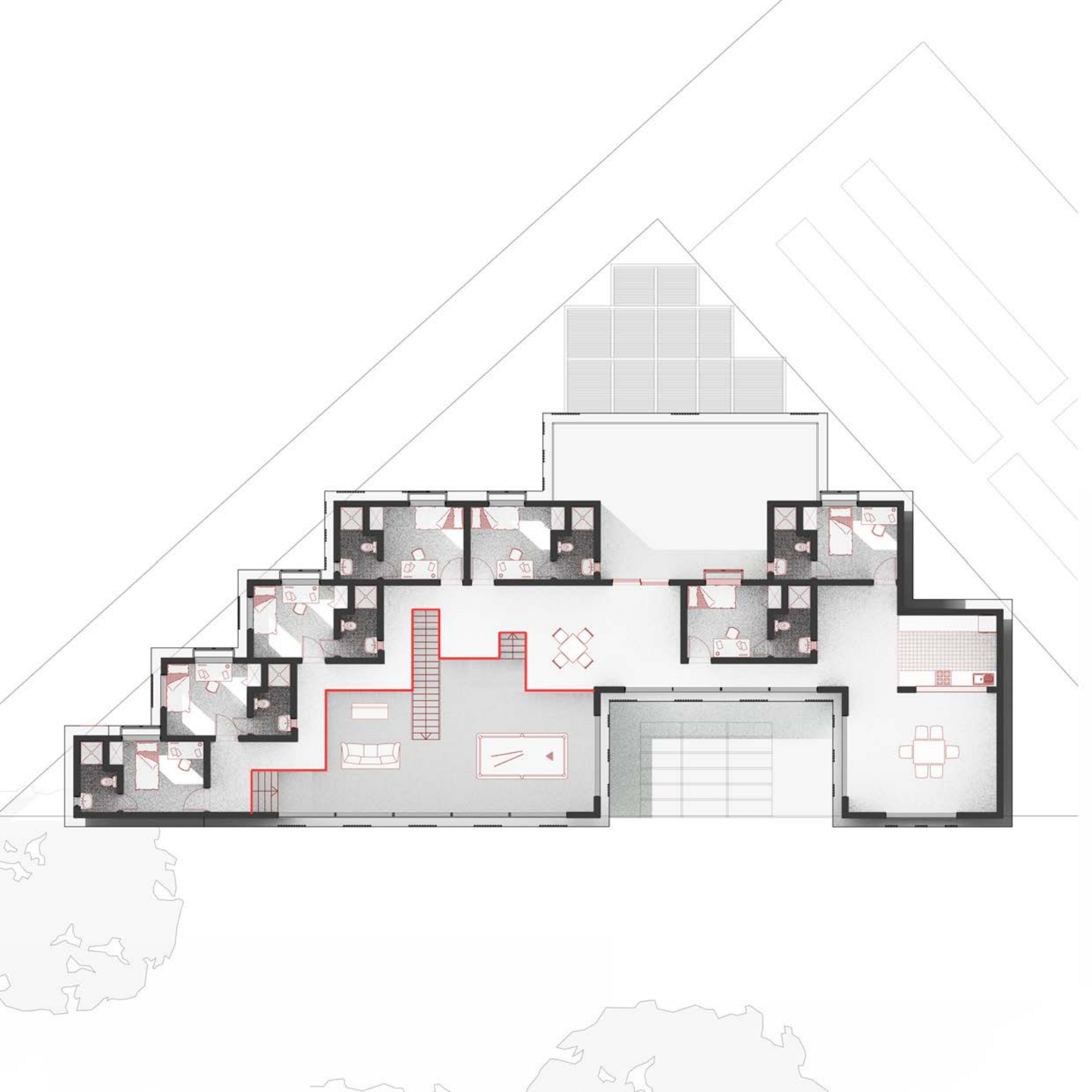





R O O M P L A N A N D S E C T I O N

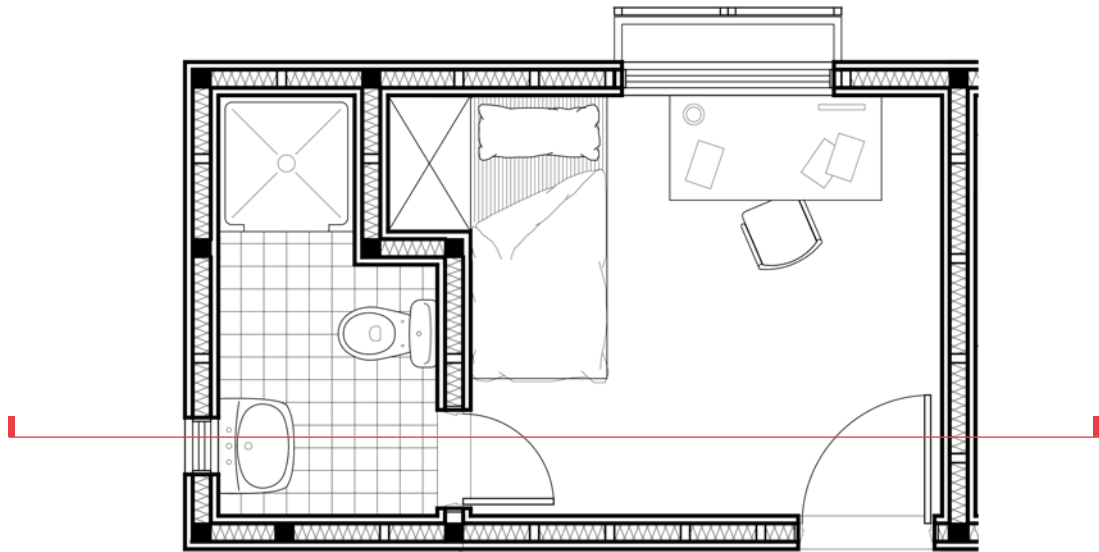

Room Plan  
1:50



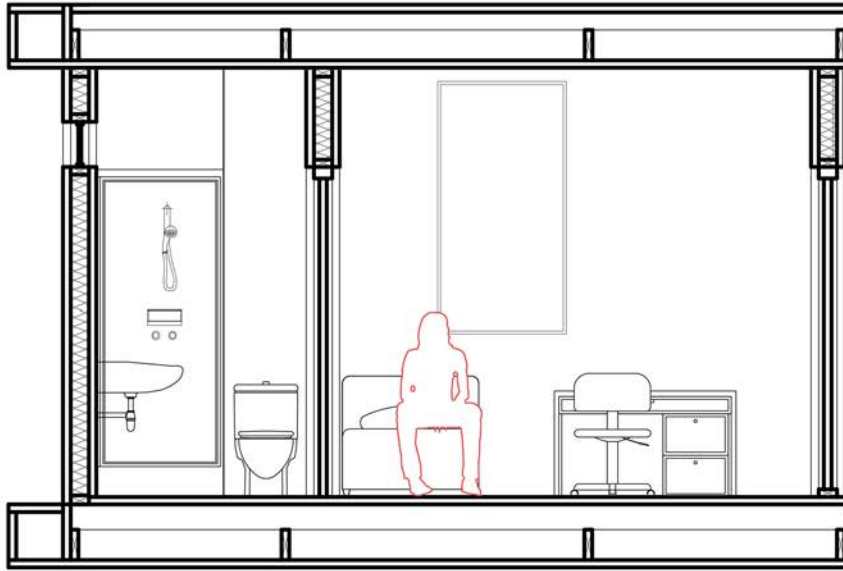

Room Section  
1:50

F R O N T F A C A D E



SECTION AND PERSPECTIVE SECTION

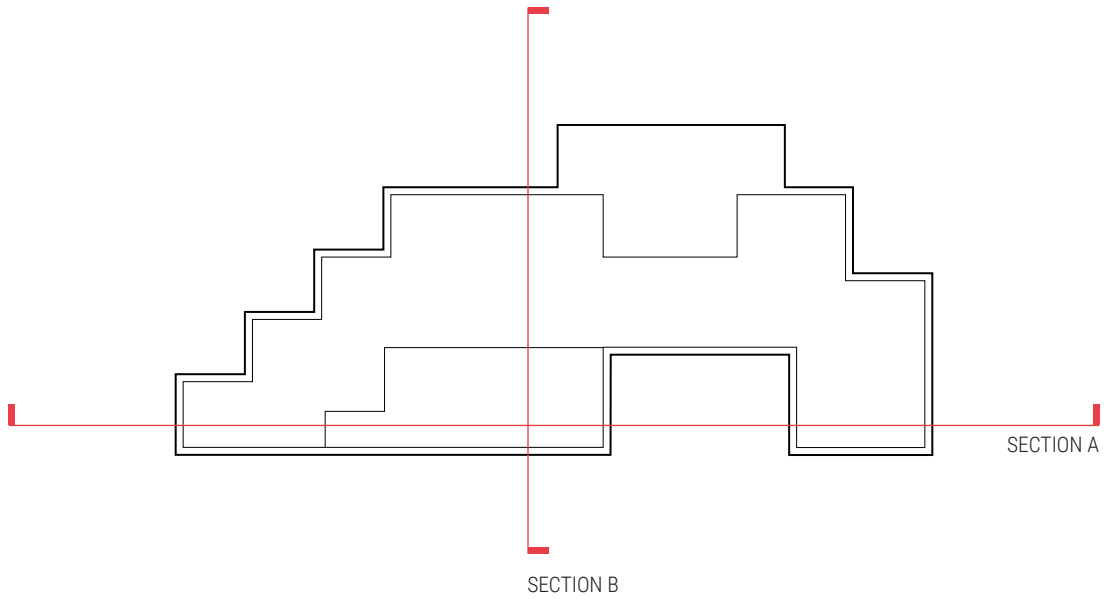







Section A  
Shrunk to Fit

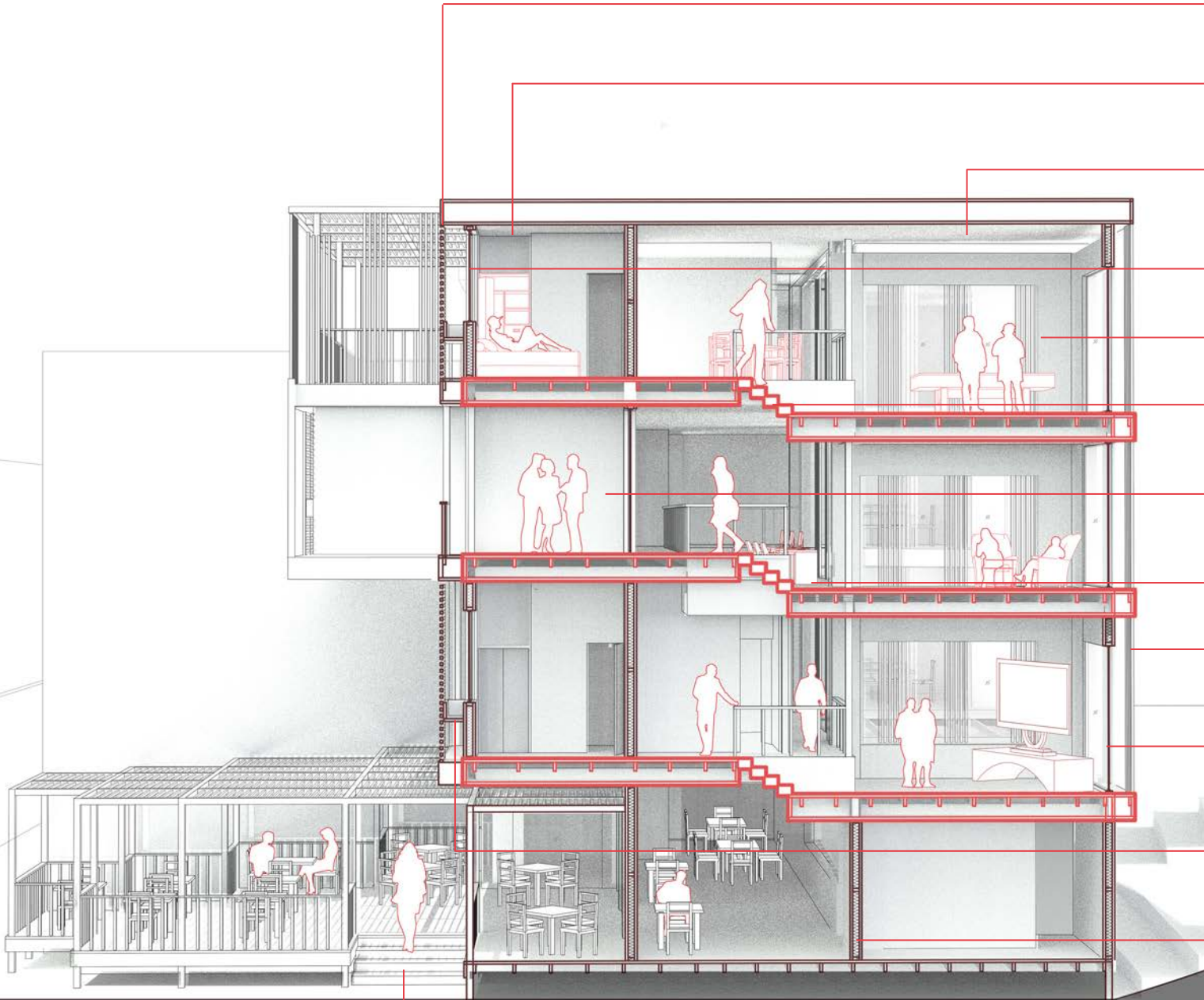

Section B  
Shrunk to Fit

- 
- 08 Operable louvres covering openings to assist in daylighting when sun becomes too bright, or for thermal comfort to protect the interior from becoming too warm due to the sun
- 
- 01 Single rooms with private bathrooms to create a sense of privacy and security and give residents the freedom to arrange the space to personalise their spaces
- 
- 07 Multiple shared common spaces with different facilities within that are open to the entire building to entertain the residents and facilitate a sense of community
- 
- 13 North facing windows for thermal comfort throughout winter by letting through maximum sunlight throughout the day with eaves to block out harsher summer sun
- 
- 08 Large openings in communal spaces that face each other to allow views into other spaces to connect the spaces and facilitate a sense of community
- 
- 02 Elevated walkways that lead to individual rooms, creating a threshold moment that separates the common spaces from the private spaces and facilitates a sense of privacy
- 
- 12 North facing, indented semi public balcony space to provide a comfortable outdoor communal space while still maintaining privacy
- 
- 10 Access to commonly used student facilities such as computers and group study spaces to provide convenience for residents
- 
- 05 Fixed louvres covering south facing openings to provide privacy from the outside
- 
- 10 South facing openings in communal spaces to provide sufficient daylight without glare, and provide a pleasant view for occupants
- 
- 04 Small external balcony spaces that allow residents to get access to an external space that they have the freedom to design and personalise
- 
- 11 Timber frame construction with insulation to provide both thermal comfort, ease of construction and maintenance and a lower construction cost
- 
- 02 Elevated platform at the entrance to the restaurant to create a threshold moment and provide a sense of privacy for occupants

C O N S T R U C T I O N

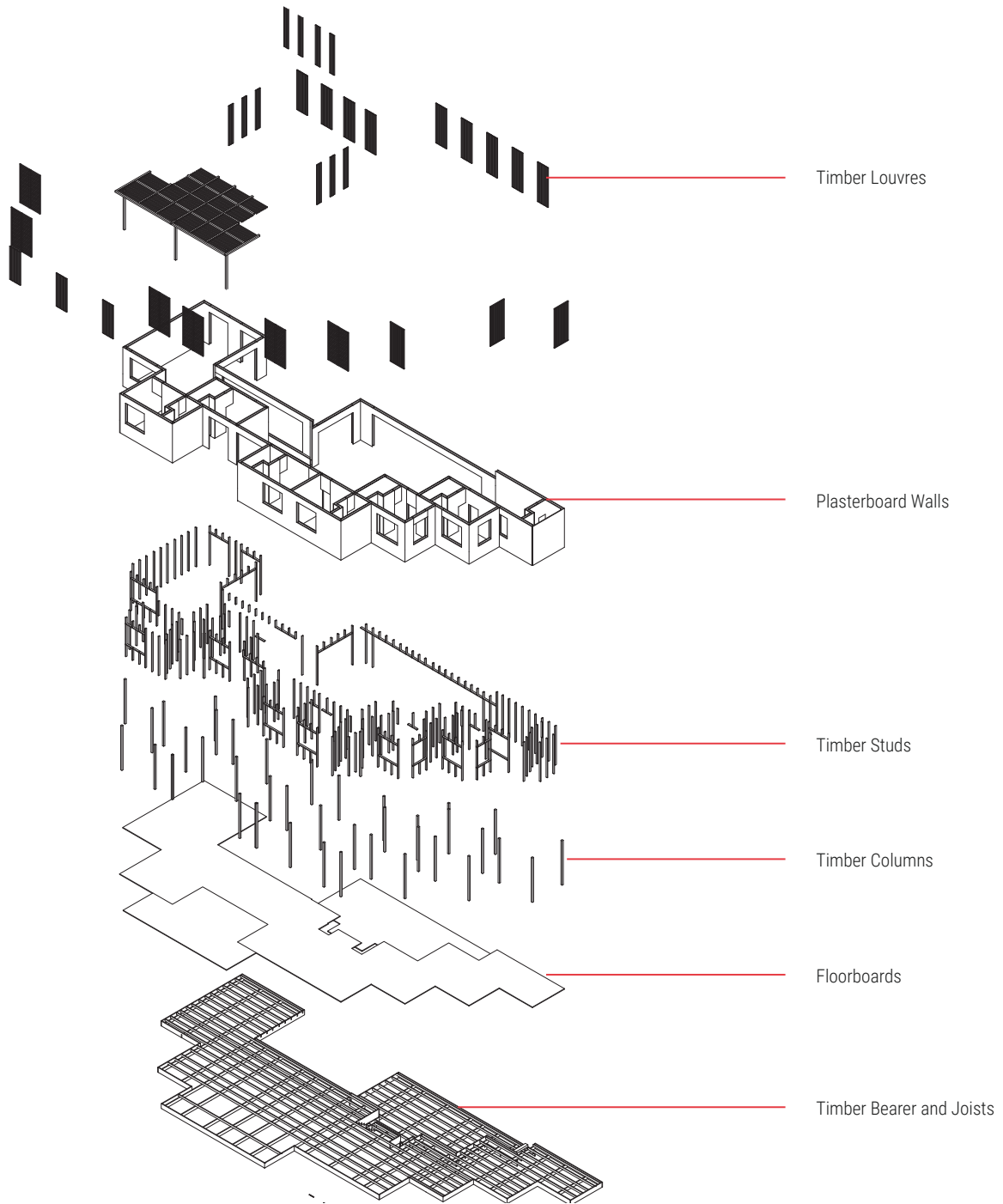



R E N D E R S







View from Communal Study Area





View from Computer desks



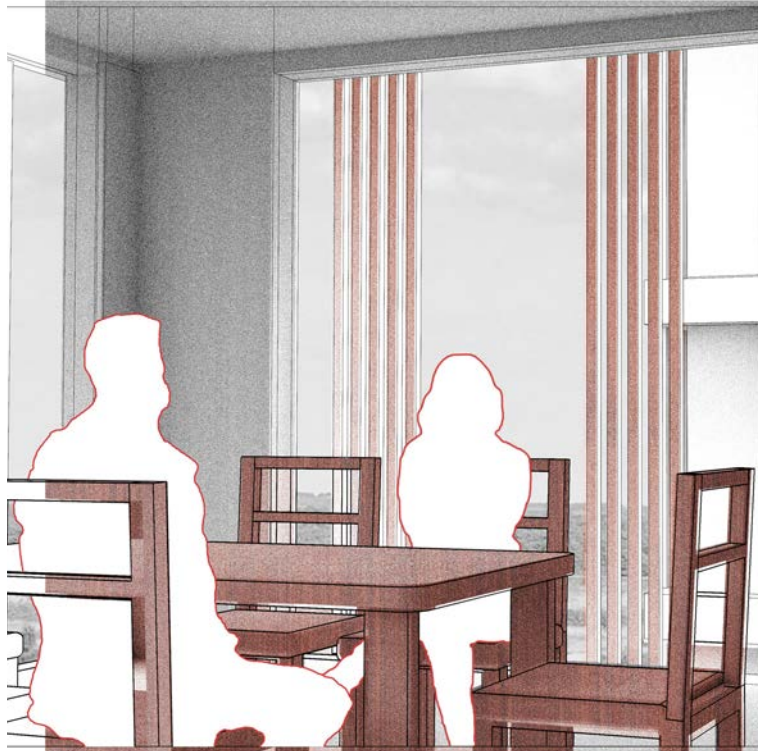

View from Communal Dining area





