

FLOOR & CEILING FINISHES:

GENERAL NOTES:

- FOR FLOOR, WALL AND ROOF TYPES REFER TO DRAWING 15E9.LO.1000 - GENERAL NOTES
- FOR STRUCTURAL INFORMATION REFER TO STRUCTURAL ENGINEER'S DETAILS AND SPECIFICATION
- DRAINAGE SHOWN INDICATIVELY REFER TO M&E ENGINEERS DETAILS AND SPECIFICATION

UNIT 1.01	UNIT 1.02	UNIT 1.03	UNIT 1.04	UNIT 1.05	UNIT 1.06
1.1.1 HALL area 8.1369 perimeter 15.1741	1.2.1 HALL area 5.3626 perimeter 10.7545	1.3.1 HALL area 8.6955 perimeter 15.8303	1.4.1 HALL area 8.0418 perimeter 15.6204	1.5.1 HALL area 7.6290 perimeter 15.6288	1.6.1 HALL area 6.3492 perimeter 13.0649
1.1.2 BATH area 4.7752 perimeter 8.9368	1.2.2 BATH area 4.5539 perimeter 8.7259	1.3.2 BATH area 4.5985 perimeter 8.7876	1.4.2 BATH area 4.6021 perimeter 8.7899	1.5.2 BATH area 4.5632 perimeter 8.7433	1.6.2 BATH area 5.0535 perimeter 10.0136
1.1.3 CPD area 1.1494 perimeter 5.0713	1.2.3 CPD area 1.5357 perimeter 4.9663	1.3.3 CPD area 1.5818 perimeter 5.5250	1.4.3 CPD area 3.3716 perimeter 7.6857	1.5.3 CPD area 1.6006 perimeter 5.6028	1.6.3 CPD area 2.3362 perimeter 6.2851
1.1.4 BED 1 area 14.6757 perimeter 17.0233	1.2.4 BED area 12.5734 perimeter 14.5748	1.3.4 BED area 12.2868 perimeter 14.0496	1.4.4 BED area 12.6478 perimeter 14.2692	1.5.4 BED area 12.6450 perimeter 14.2675	1.6.4 BED area 11.0756 perimeter 13.9696
1.1.5 EN-SUITE area 3.9970 perimeter 8.3884	1.2.5 LIVING area 20.5534 perimeter 20.2698	1.3.5 LIVING area 18.6485 perimeter 17.9331	1.4.5 LIVING area 18.6485 perimeter 17.9331	1.5.5 LIVING area 23.0366 perimeter 20.5855	1.6.5 LIVING area 20.3675 perimeter 22.7102
1.1.6 BED 2 area 14.0906 perimeter 15.6498	1.2.6 KITCHEN area 7.1252 perimeter 10.5776	1.3.6 KITCHEN area 7.8338 perimeter 11.4147	1.4.6 KITCHEN area 7.9659 perimeter 11.4193	1.5.6 KITCHEN area 9.1565 perimeter 13.4310	1.6.6 KITCHEN area 9.8620 perimeter 13.7287
1.1.7 LIVING area 19.7918 perimeter 19.5423					
1.1.8 KITCHEN area 11.5721 perimeter 15.4195					

KEY
Read in conjunction with 15E9.LO.1000 'General Notes'

- Existing structure
- Existing structure drylined (Note 3a, 3b)
- New concrete retaining walls (Note 3c)
- New external wall (Note 3d - Type 1)
- New external wall (Note 3d - Type 2)
- New external wall (Note 3e)
- New metal stud separating wall (Note 7a)
- New blockwork separating wall (Note 7b)
- New internal metal stud partition (Note 8a)
- New blockwork wall (Note 8b - Type 1,2,3)
- Safety eyebolt

This drawing must not be reproduced without permission.
Contractor to check all dimensions on site.
Report discrepancies to the architect.



FLOOR & CEILING: COMMON AREAS:

1.0.1 LOBBY:
area 11.8034
perimeter 18.0623

LIFT:
area 7.6515
perimeter 11.1834

SERVICE RISER:
area 5.6926
perimeter 9.5734

1.0.2 CORRIDOR 01:
area 15.3729
perimeter 23.4083

1.0.3 CORRIDOR 02:
area 15.7076
perimeter 23.3820

1.0.4 LOBBY
area 2.3202
perimeter 6.9558

SMOKE VENT 01:
area 1.9967
perimeter 5.6656

SMOKE VENT 02:
area 1.9967
perimeter 5.6656

T1	22.12.17	WHL
TENDER ISSUE		
rev	amendments	date by



55 Kingstown Street
London NW1 8JP
T +44 (0) 20 7436 1133
W ipa-architects.com

Project
16 THE VALE
ACTON
W3 7SB

Drawing Title
PROPOSED
FIRST FLOOR PLAN

Drawing Status
TENDER

Date 07/08/17 Drawn by WHL

Scale A1 @ 1:100 A3 @ 1:200

Drawing No. 15E9.LO.1001 Rev T1

Code File 15E9.LO.1001 (1ST)

© IPA Architects. All rights reserved.

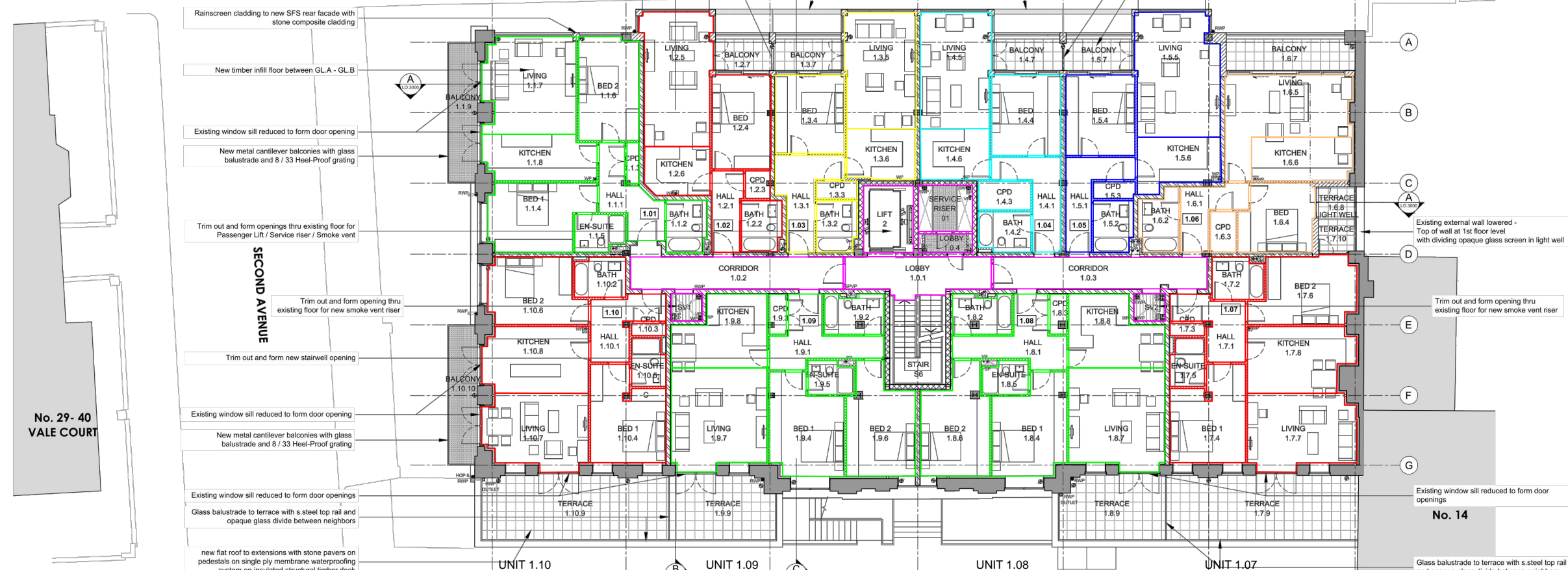

1 PROPOSED FIRST FLOOR PLAN
Scale: 1:100 @ A1

