

The background image shows a modern architectural interior. On the left, there is a grey modular sofa. A large window with a grid pattern dominates the center, offering a view of a coastal landscape with mountains and a body of water. The ceiling features a large, multi-bladed ceiling fan and recessed lighting. The overall aesthetic is clean and minimalist.

ARCHITECTURAL PORTFOLIO

AVNINDERPAL SINGH

AVNINDERPAL SINGH

D.O.B - 13 Feb 1995

Hometown - Ludhiana

Email - Dezineaps@gmail.com

Contact - 7889126527

Permanent Address - H.No. 8477, Guru Angad Colony, ATI Road, Ludhiana

Correspondence Address - H.No.C2/5, S.B.S. State Technica Campus, Firozpur

EDUCATION

B.Architecture - Giani Zail Singh College of Engineering & Technology

2014 - 2019

COURSES

Diploma in Id Grafix(3ds Max and Autocad)-2016

INTERNSHIP

H.S.Sehgal & Associates, Ludhiana

Prolific Architects, Ludhiana

PROFESSIONAL EXPERIENCE

Dynamic Architects, Ludhiana

(2019-2020)

COMPITETIONS

Transparence 13.0 by Saint Gobain and Ethos India - North Zone Finalist

SOFTWARE PROFICIENCY

Autodesk Autocad

Trimble Sketchup

Vray

Lumion

Twinmotion

Adobe Photoshop

Adobe Lightroom

M.s.office

SKILLS

Architectural Drawing

Conceptual Sketching

Photography

Physical Model Making

LANGUAGES

English

Hindi

Punjabi



ABOUT ME

Graduation served me as foundation for finding different techniques and approaches to design process.

Projects over all the years have focused on a domestic scale allowing myself to build my own experiences in understanding and representing architectural spaces.

"The more we explore, more we learn"

ELEVATION DESIGN
FOR A RESIDENCE
AT HAMBRAN ROAD





DRAWING ROOM
FOR A RESINDENCE
AT HOSHIARPUR



VENEER PANELING WITH STONE
TEXTURE WALLPAPER,PADDED &
NON PADDED LEATHER PANELING



DRAWING ROOM CONCEPT

SUCUPIRA VENEER, METAL PROFILES, WOODEN LOUVERS, CHAMPAGNE LACQUER GLASS WITH CHROME.



MASTERBEDROOM DESIGN + SITTING CONCEPT



STONE & METAL INLAY WORK
LEATHER PATTERN BED BACK
ROTATING TV UNIT WITH ELECTRIC
FIRE PLACE BELOW
WALLPAPER ON CEILING



BEDROOM DESIGN RESIDENCE AT SOLAN

WALLPAPERS, STONE VENEER,
WOODEN FLOORING, WOODEN
CEILING, LEATHER BEDBACK WITH
LOUVERS





CLASSICAL THEME
BEDROOM FOR A
RESIDENCE AT SOLAN

WHITE & BEIGE





OFFICE INTERIORS

HIGH GLOSS VENEER, FLEX STONE, ROUGH LIMESTONE,
WOODEN CEILINGS AND LOUVERS, FABRIC PANELING



INTERIOR DESIGN FOR A SAMPLE ROOM AT GARMENT FACTORY



LACQUER GLASS WITH METAL
FRAMES, WOODEN PANELS,
STONE VENEER, BUTTOCHINO &
ARMANI GREY FLOORING



COMMUNITY HALL ELEVATION





COMMUNITY HALL INTERIOR

WOODEN CEILINGS, GLASS PANELING,
JALI WORK, DUPONT, BEVELLED MIRRORS
FLOOR PATTERNS, MARBLE CLADDING
METAL PROFILES IN CEILINGS.



ELEVATIONS FOR
VARIOUS PROJECTS



THESIS - AUTOMOBILE MUSEUM

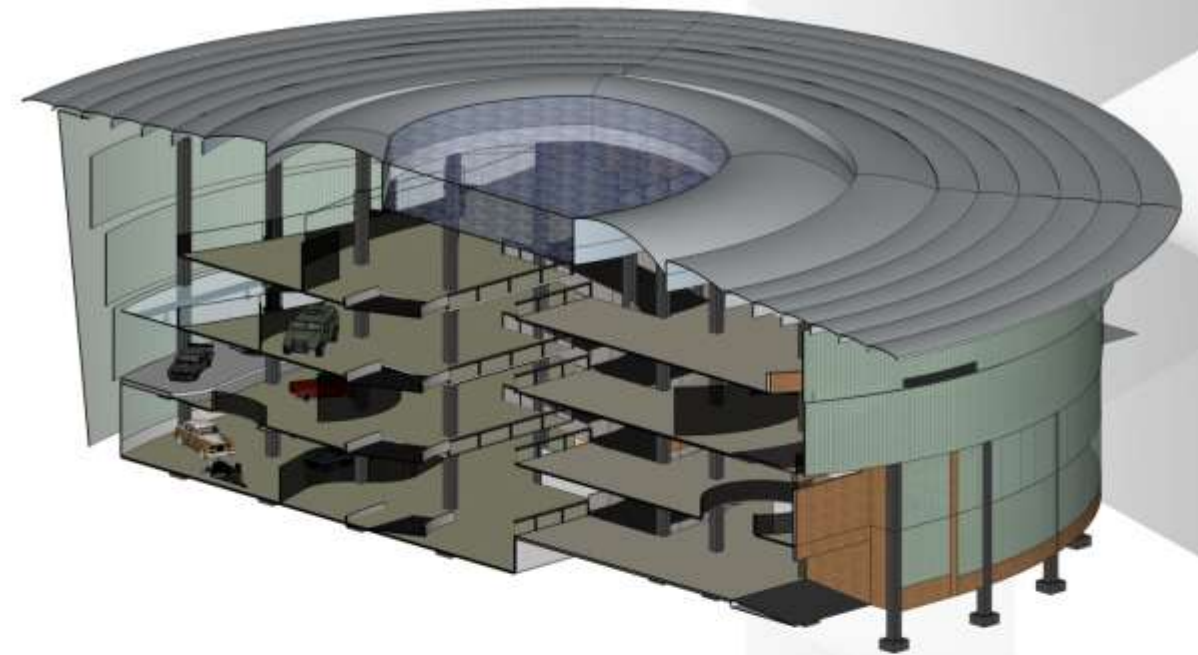
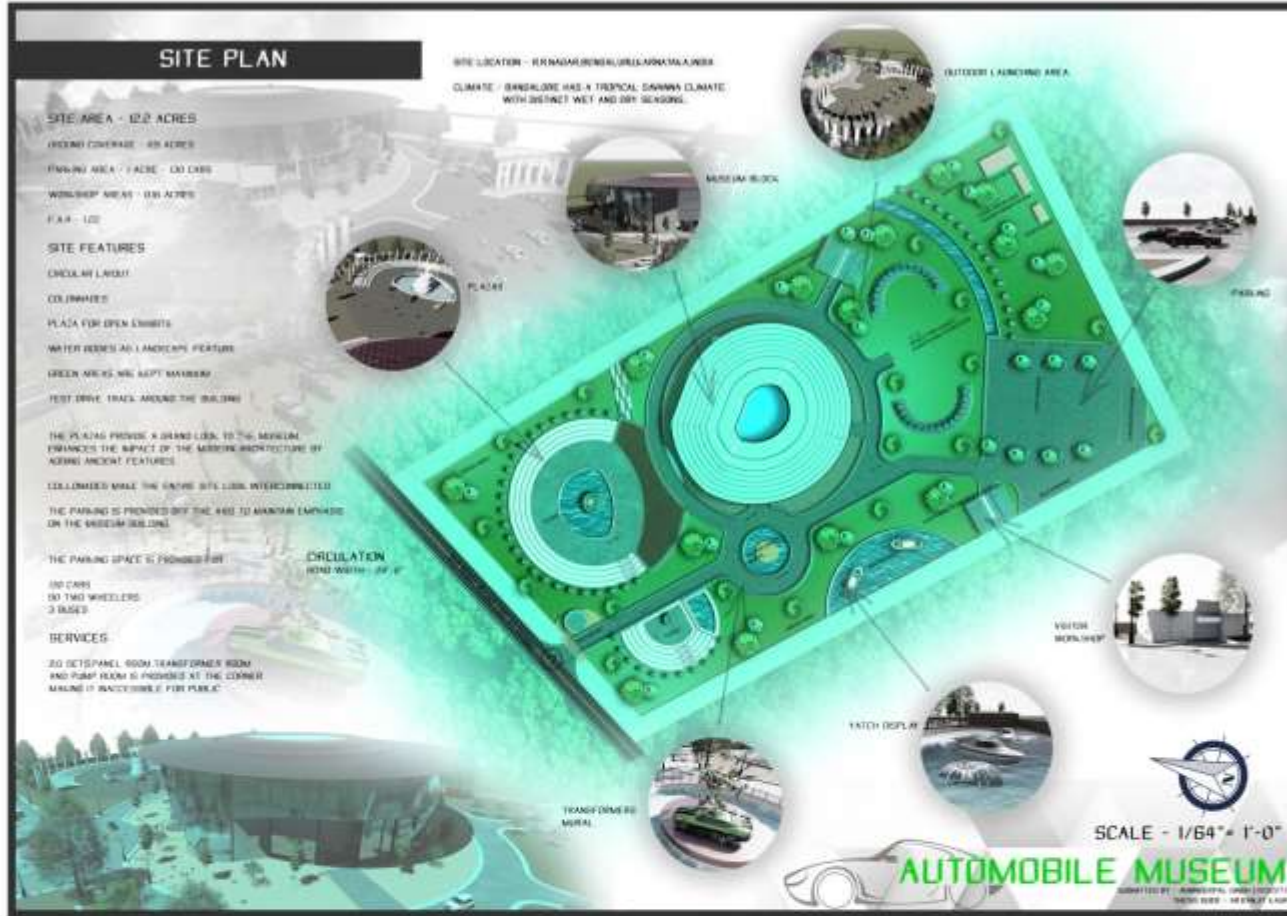

THESIS - AUTOMOBILE MUSEUM

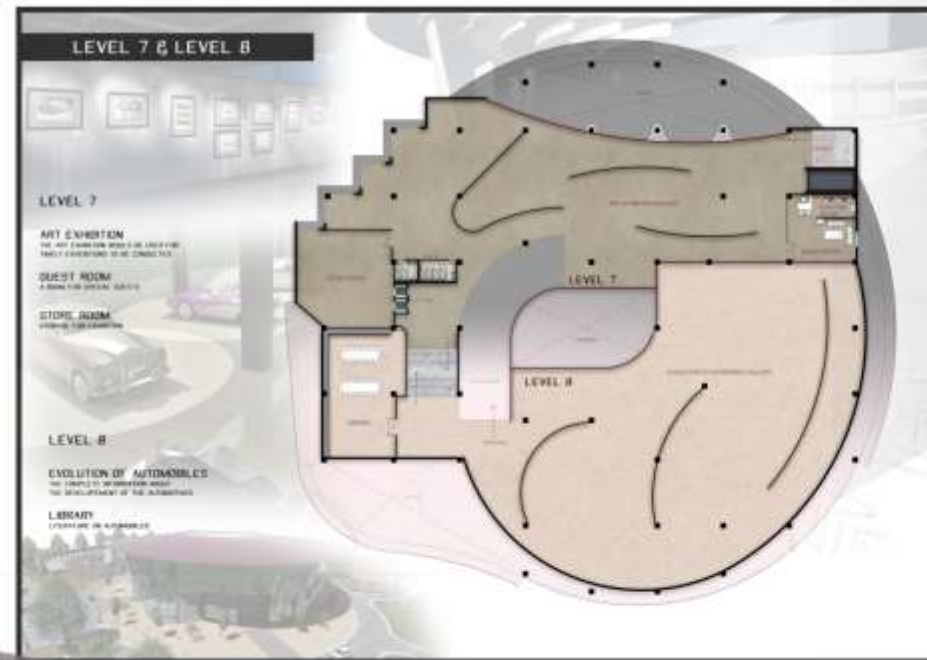
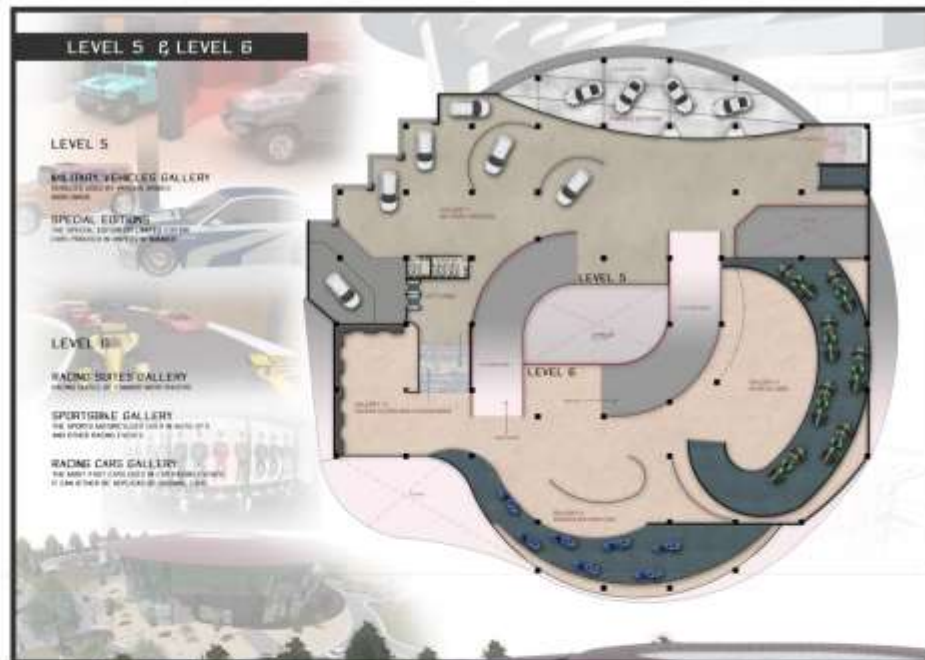
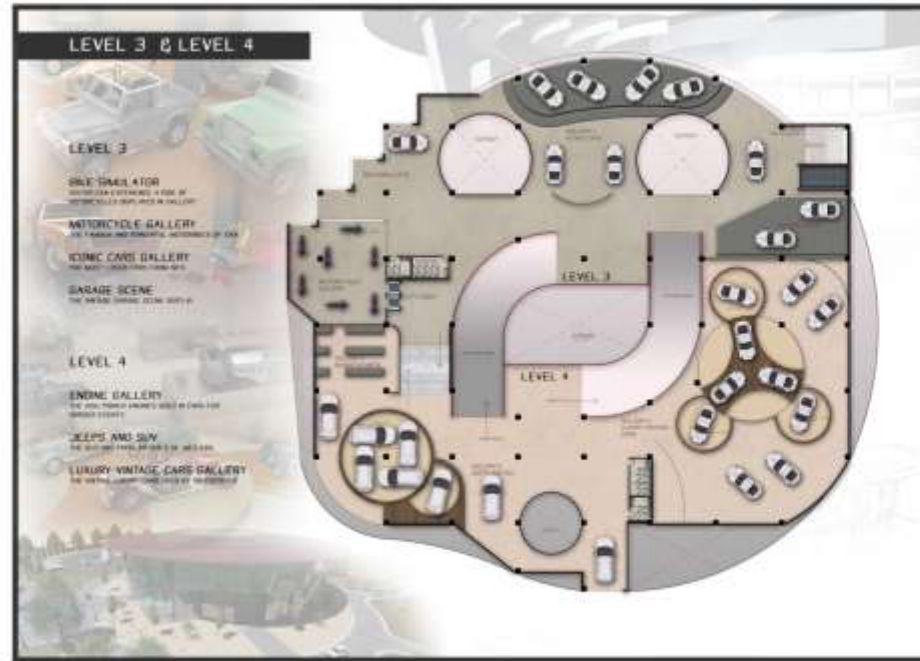

NORTH ZONE FINALIST TOPIC - OFFICE TOWER

VIVACITY TOWER



SMART OFFICE BUILDINGS: WHAT FEATURES DO PEOPLE REALLY WANT?



A LOCATION, USUALLY A BUILDING OR PORTION OF A BUILDING, WHERE A COMPANY CONDUCTS ITS BUSINESS. A COMPANY CAN HAVE JUST ONE OFFICE, KNOWN AS ITS HOME OFFICE, OR A MAIN OFFICE AND A VARIETY OF FIELD OFFICES OR BRANCH OFFICES. ALL OF THESE OFFICES ARE INVOLVED IN SOME WAY IN THE BUSINESS OF THE COMPANY.

WORKPLACE DESIGN CAN BE OVERLOOKED WHEN TRYING TO SOLVE THE CAUSES OF LOW PRODUCTIVITY

"PEOPLE KNOW WHAT THEY DON'T WANT AT WORK-A SEA OF BLAND, UNIFORM SPACES WHERE IDEAS GO TO DIE... MOST ORGANIZATIONS ONLY PROVIDE PEOPLE WITH THE TECHNOLOGY AND PERMISSION TO WORK IN INFORMAL SPACES, BUT WHAT'S MISSING IS THE RANGE OF SPACES WHERE PEOPLE WANT TO WORK THAT SUPPORT THEIR PHYSICAL, COGNITIVE AND EMOTIONAL WELLBEING... IN THE OFFICE, ORGANIZATIONS MUST PROVIDE PEOPLE WITH TECHNOLOGY, (AND) A DIVERSE RANGE OF SPACES THAT SUPPORT DIFFERENT TYPES OF WORK AND PERMISSION TO USE THESE SPACES IF THEY EXPECT THEM TO THRIVE"

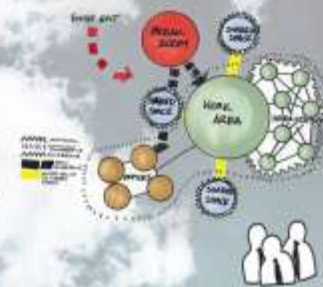

MAKING INFORMAL WORKSPACES BETTER

ON BEING QUIZZED HOW INFORMAL WORKSPACES CAN BE MADE BETTER, AND MORE EFFECTIVE, THE FOLLOWING ARE THE MAXIMUM NUMBER OF TAKERS

MORE VIEWS OF GREENERY AND NATURE (49%)

BETTER SUPPORT FOR INFORMAL INTERACTIONS (41%)

MORE ACCESS TO PRIVATE SPACES FOR ACOUSTIC AND VISUAL PRIVACY (38%)

BETTER ERGONOMICS (37%)

HERE ARE FOUR KEY ASPECTS OF OFFICE DESIGN THAT CAN AFFECT PRODUCTIVITY

1. PERSONAL WORKSPACES
2. ERGONOMICS
3. ENVIRONMENTAL DESIGN
4. TYPES OF WORKING SPACES



LOCATION AND PERCEPTIONS MATTER

EMPLOYEES FROM CHINA AND INDIA WERE FOUND TO BE SPENDING THE LEAST AMOUNT OF TIME AT THEIR OWN WORKSTATION AND THE MAXIMUM TIME IN COLLECTIVELY OWNED AND SHARED WORKSPACES

WORKERS IN USA AND GERMANY, ON THE OTHER HAND, SEEM TO BE MORE TRADITIONAL AND TEND TO STICK TO THEIR OWN WORK DESKS THE MOST

ORGANISATIONS IN INDIA AND CHINA ARE MORE PROGRESSIVE AND OFFER MORE SHARED SPACES THAN COMPANIES IN OTHER COUNTRIES

ORGANISATIONS THAT OFFER MORE CASUAL AND INFORMAL SPACES ARE PERCEIVED TO BE MORE PROGRESSIVE THAN THOSE WHO DON'T

TRANSPARENCE 2018

VIVACITY TOWER



TOTAL NO. OF FLOOR : 18+2 BASEMENTS

AREA STATEMENT

SITE AREA : 110828 SQ. FT. (2.54 ACRES)

FLOOR AREA :

23,459 SQ. FT. (WITH TERRACE , 7 NOS)

21,749 SQ. FT. (WITHOUT TERRACE , 6 NOS)

10,560 SQ. FT. (TOP 3 NOS)

BASEMENT AREA : 58,325 (498 CARS)

TOTAL BUILT UP AREA : 4,05,906 SQ. FT

F.A.R : 3.157



GROUND FLOOR PLAN

TYPICAL PLAN



ELEVATIONS

FRONT

BACK

LEFT

RIGHT



SITE SECTION

VIVACITY TOWER

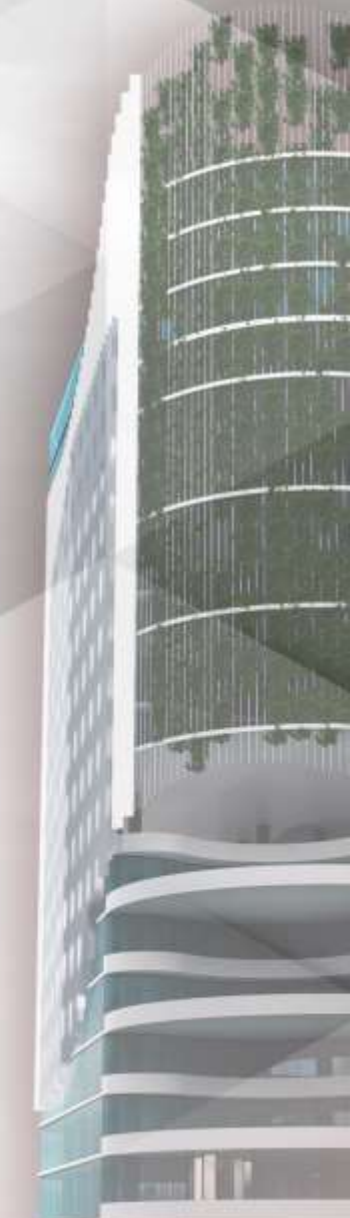

NORTH ZONE FINALIST TOPIC - OFFICE TOWER



VIVACITY TOWER

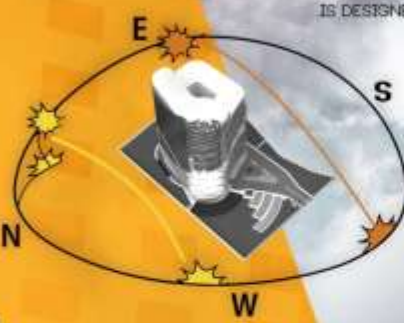



DESIGN CONCEPT

FORM - THE BUILDING MOST DYNAMIC FEATURE IS ITS FACADE. CONSIDERING THE HEIGHT AND PRESENCE OF THE TOWER, IT REQUIRES FOR SOMETHING THAT MAKE A STRONG STATEMENT IN TERMS OF ITS ENVELOPE'S EFFICIENCY. THIS IS ACHIEVED BY CREATING A PASSIVE TYPE OF FACADE THAT IS RESPONSIVE TO THE DIFFERENT SUN-SHADING REQUIREMENTS. MOST OF THE ELEVATION FACING THE SOUTH-WEST DIRECTION WILL HAVE A VERTICAL SUN SHADING IN A WAVE FORM LAYOUT TO CREATE A BEAUTIFUL SHADOW EFFECT IN THE INTERIOR. NOT ONLY THAT, THE FLOOR PLANS LAYOUT IS DESIGNED IN 'V' SHAPE TO REDUCE DIRECT ANGLE OF SUNPATH.

SITE LOCATION - YESHWANTPUR AREA, BANGALORE, KARNATAKA

THE CLIMATE HERE IS TROPICAL. THE SUMMERS ARE MUCH RAINIER THAN THE WINTERS IN BENGALURU. THE TEMPERATURE HERE AVERAGES 23.8°C. IN A YEAR, THE AVERAGE RAINFALL IS 831 MM.

BANGALORE

DESIGN FEATURES

- BUILDING'S CONNECTIVITY WITH THE SITE
- THE BUILDING EVOLVES FROM THE SITE SO THAT THE PERSON APPROACHING DO NOT SEE A RIGID BUILDING ENVELOPE.
- IT IS DONE SO THAT THE BARRIER OF INNER SPACE FROM OUTER SPACE CAN BE ELIMINATED.
- LOUVERS ARE GIVEN TO CUT THE SUN FACT AS VISUAL BARRIER FOR OUTSIDE WORLD.
- INTERACTION ZONES ARE INTENDED IN THE WORKSPACES.
- HEALTHY INTERACTION BETWEEN EMPLOYEES IMPROVES THE PERFORMANCE, SO GREEN TERRACES AND OUTGOITS ARE PROVIDED.
- DOUBLE HEIGHT GREEN TERRACES THEY ARE PROVIDED AT EVERY ALTERNATE FLOORS.



VIVACITY TOWER



VISION

BETTER HEALTH
LOWER STRESS LEVELS
HIGHER PRODUCTIVITY
IMPROVING MENTAL HEALTH



GREEN TERRACE

HEALTHY INTERACTION BETWEEN EMPLOYEES IMPROVES THE PERFORMANCE, SO GREEN TERRACES AND OUTGOITS ARE PROVIDED.

DOUBLE HEIGHT GREEN TERRACES THEY ARE PROVIDED AT EVERY ALTERNATE FLOORS.

FLUIDIC APPROACH

BUILDING'S CONNECTIVITY WITH THE SITE. THE BUILDING EVOLVES FROM THE SITE SO THAT THE PERSON APPROACHING DO NOT SEE A RIGID BUILDING ENVELOPE.

GREEN POCKETS & WALLS

REDUCE STRESS
INCREASE PRODUCTIVITY
CLEAN THE AIR
BOOST CREATIVITY
MAKE WORKSPACE ATTRACTIVE
REDUCE SICKNESS

GYM & RECREATION AREA

LOWERS STRESS
FACILITATES EMPLOYEES TO SQUEEZE GYMING INTO WORK-SCHEDULE.

GREEN FLOOR

CAN BE USED AS PARTY AREA
INTERACTION AREA
RECREATION AREA

ALTERNATE FLOORS

FIRST FLOOR

GROUND FLOOR

TRANSPARENCE 2018

TRANSPARENCE 2018